

LED3W350B

Features:

- Compact size that maximizes design flexibility.
- 110, 220, 240 full range AC input.
- Tight regulated constant current output to maximize LED performance.
- Screw terminal wiring.



AC Input Voltage:	100-240V, 50/60Hz
DC Output Voltage:	4~12V
DC Output Current:	350mA Constant
Output Wattage:	1~3W
Short Circuit Protection:	Yes
Overload Protection:	Yes
Thermal Protection:	Yes
Dimming Function:	No
Operating Temperature:	-10~60°C (14~140°F)
Max. Case Temperature:	70°C (158°F)
Humidity (non-condensing):	20%~95%
Case Material:	Non Conductive Black/White Plastic
Weight:	55g (1.94 Oz)
Approval:	UL Listed.

Dimension:

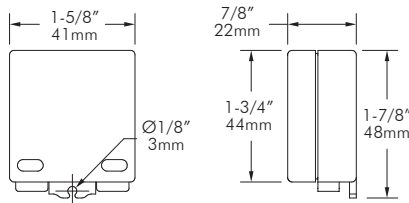

Wiring:

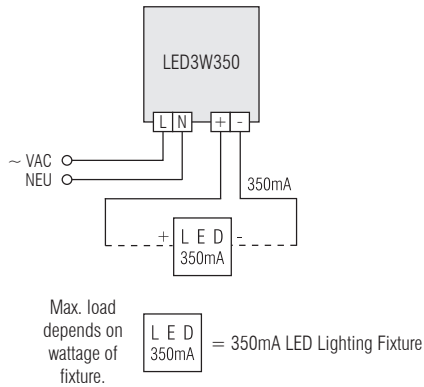

* Consult factory for wiring length and details.

* Caution: Do not install on-off switch at the output (load) side of a constant current LED driver as it will damage the fixture(s). Warranty will be void on both driver and fixture(s).

Order Code	Enclosure
LED3W350	B
	B = drive enclosure (6-1/4" x 5" x 2")

Type:

Project:

Modified:

Quantity:

Notes: