

L123

Linear LED
with Projectors

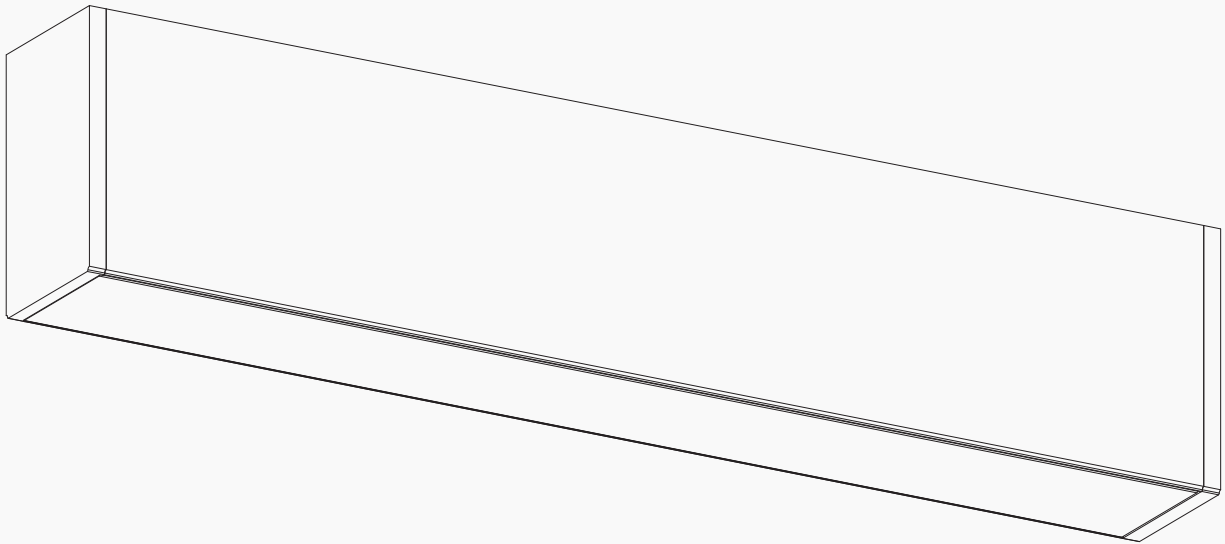

L123

Fixture Disassembly Diagram Projectors

Fixture Disassembly

Disassemble fixture housing before securely mounted to structure.

- 1) Remove both end caps. Pull end cap out from each side of the fixture housing.
- 2) Remove inner projector rail by pulling away from magnets.
- 3) Remove driver housing cover plate and disconnect projector wires.

Notes: Leave wire connected from driver to dimming module.

Notes: Reinstall end caps before rail is secured to structure.

**To attach end caps push the 4 pins into the screw-ports on the end of the fixture housing.

Parts

LED fixture Housing
 2 x End Caps
 Lens
 Inner rail
 Mounting Bracket
 Driver & driver housing
 Dimming module (optional)

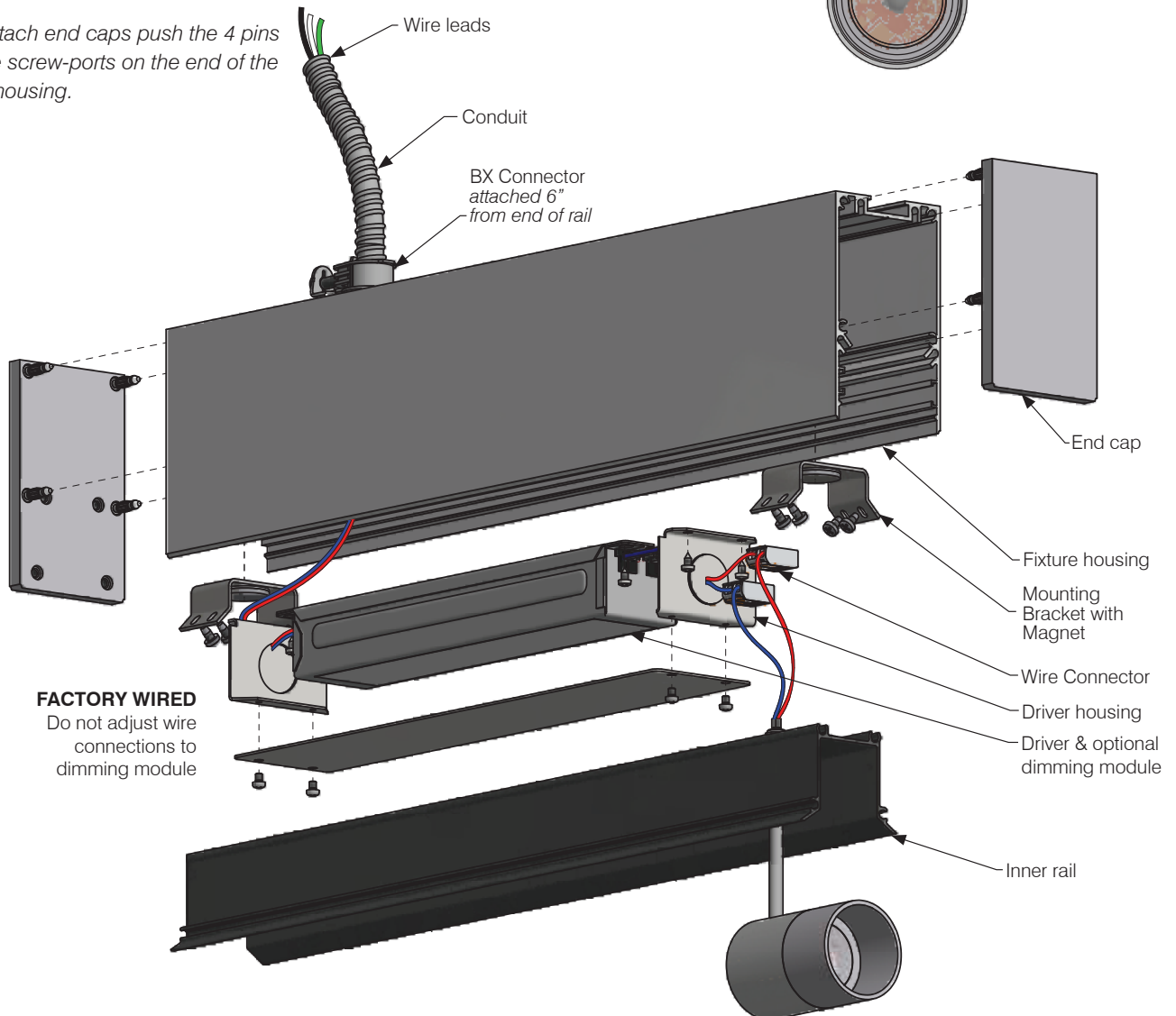
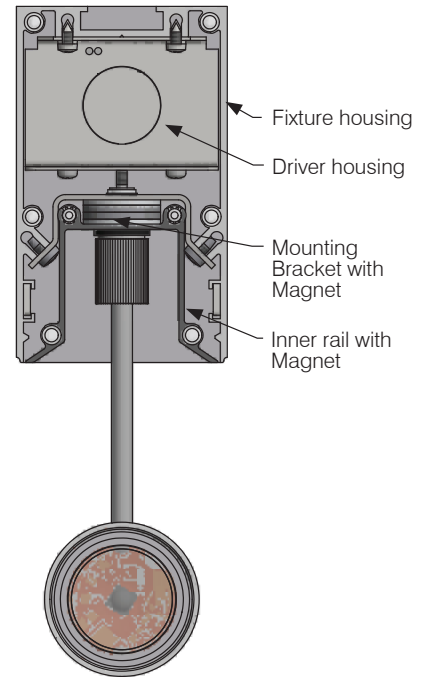

FACTORY WIRED
 Do not adjust wire connections to dimming module

L123

Recessed Ceiling Mount

Parts

LED fixture Housing
2 x Wire Connectors
Mounting screws (supplied by others)

- 1) Turn off power prior to installation.
- 2) Drill 7/8" hole in fixture housing in appropriate location for the power feed.
- 3) Box in fixture with 2x4 framing
- 4) Mount fixture housing by screwing housing to 2x12 or 2x10 ceiling joist. Place screws approximately 2" from housing ends and evenly spaced to a maximum of 2' apart. Ensure fixture is level.
- 4) Install drywall, butt up to edges of housing leaving a 1/8" gap for caulking.
- 6) Apply layers mud / joint compound over the gap with a drywall knife. Ensure no mudding dries on inside of the housing.

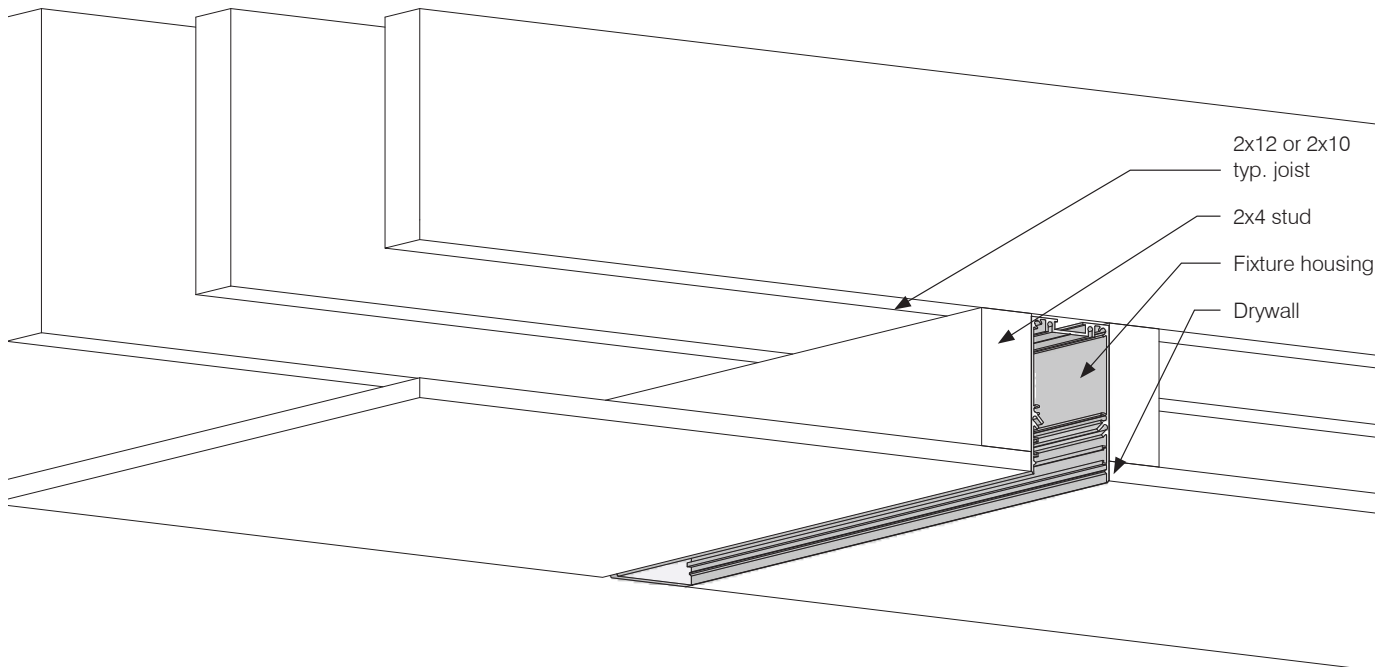
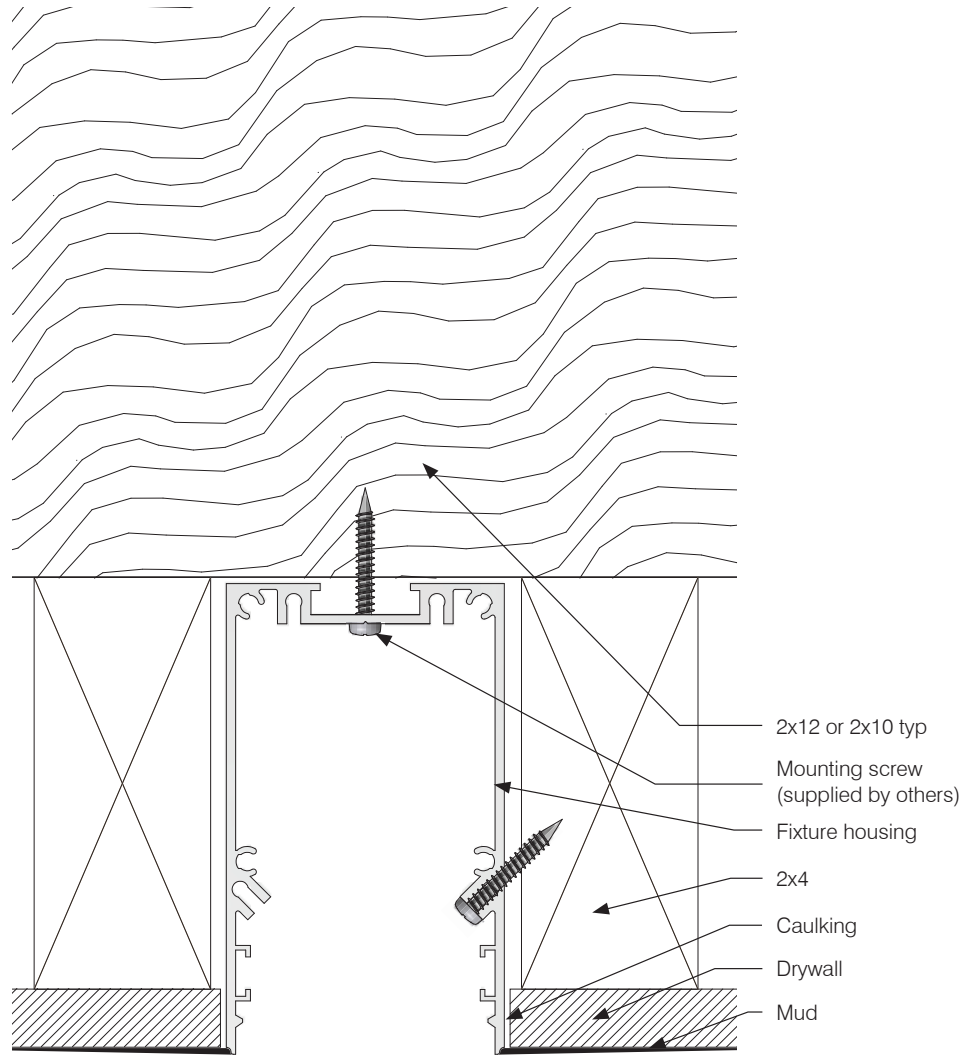

L123

Fixture Assembly Diagram Projectors

Fixture Assembly

Once fixture housing is securely mounted to structure re-assemble fixture.

Parts

- LED fixture Housing
- 2 x End Caps
- Lens
- Inner rail
- Mounting Bracket
- Driver & driver housing
- Dimming module (optional)

- 1) Make power connection to wire leads by bringing in Line Voltage and making connection to driver.
- 2) Reconnect driver wires to projector wires.
- 3) Replace driver housing cover plate.
- 4) Push up inner rail until it reconnects with magnets on mounting brackets.

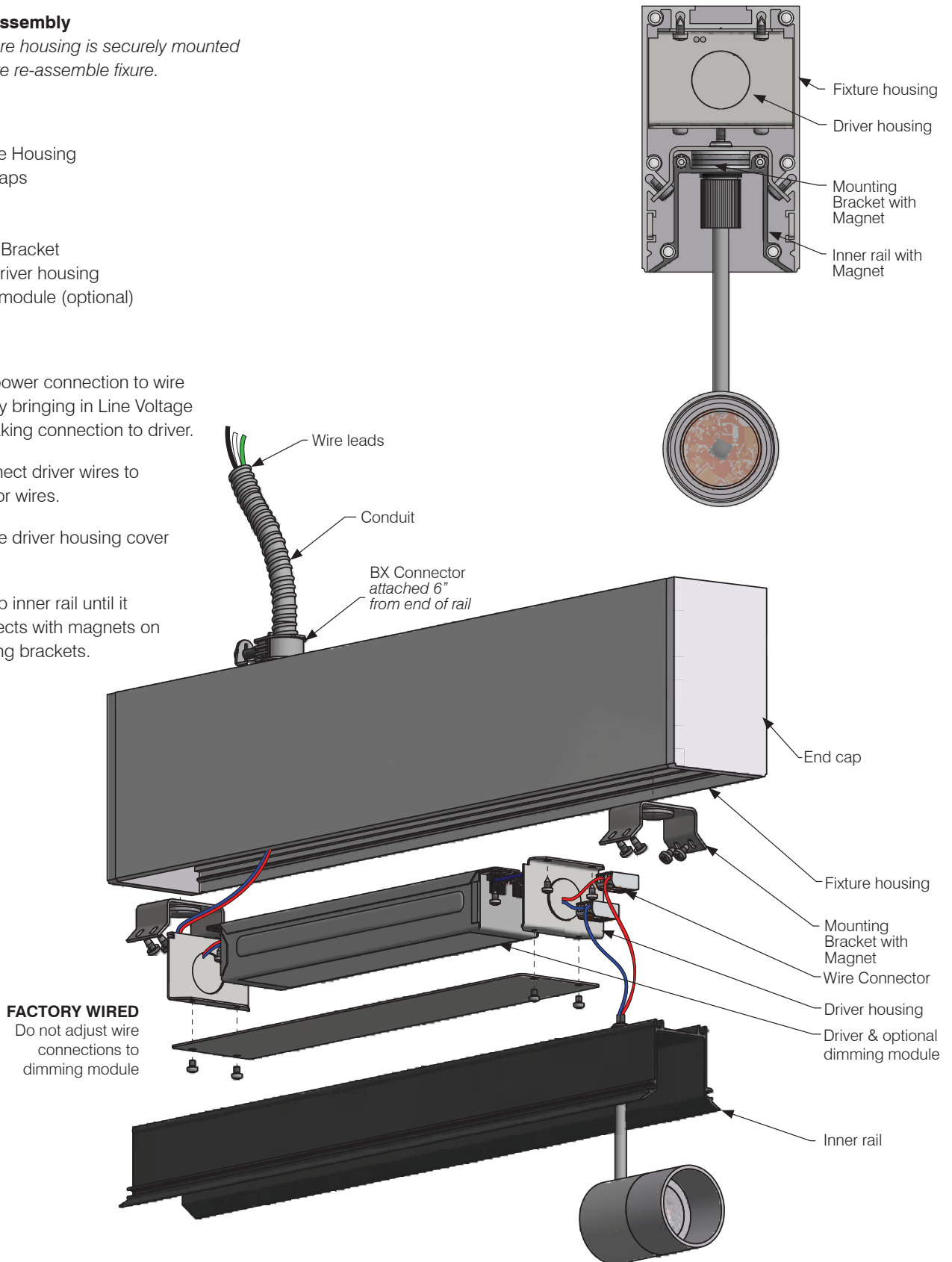

L123

Fixture Assembly with Blank Section

Parts

LED fixture Housing
2 x End Caps
Lens
LED inner rail
Cover

Fixture Assembly

Once fixture housing is securely mounted to structure re-assemble fixture.

- 1) Push up inner rail until it reconnects with magnets on mounting brackets.

*To attach end caps push the 4 pins into the screw-ports on the end of the fixture housing.

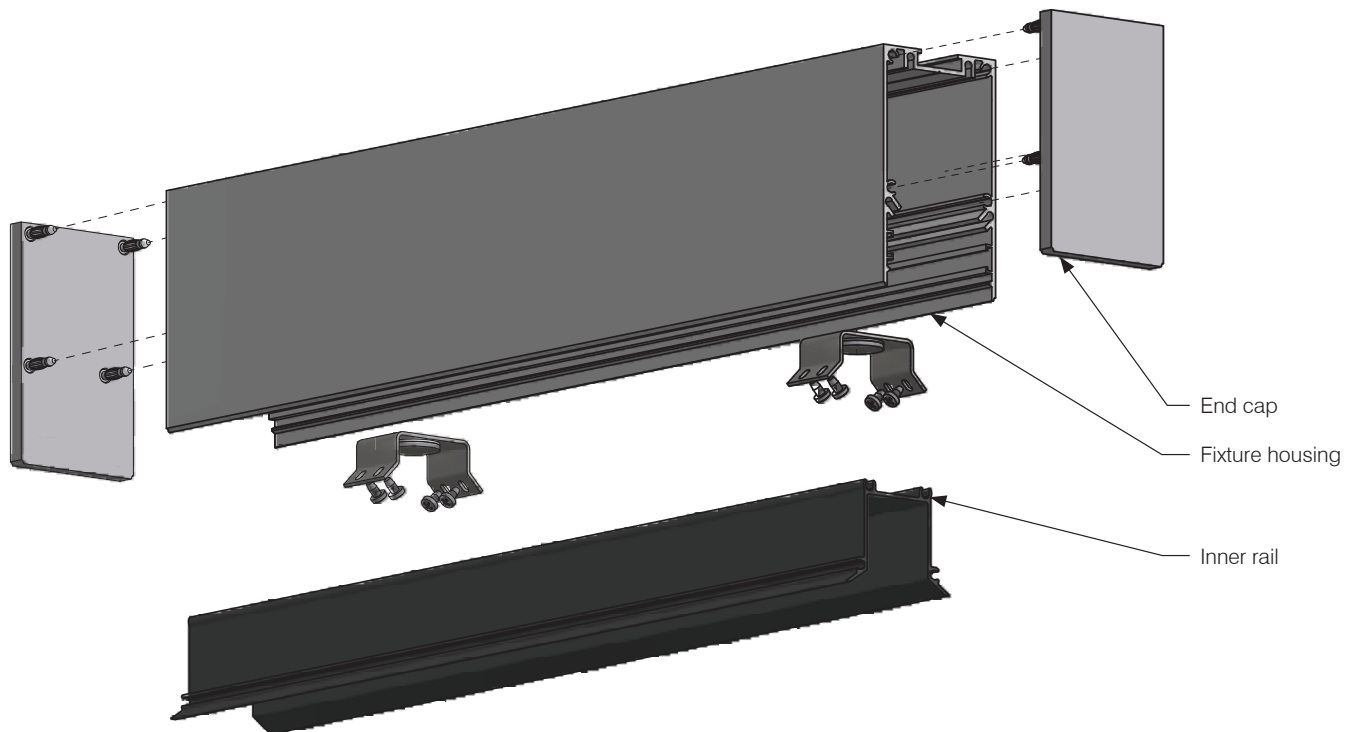
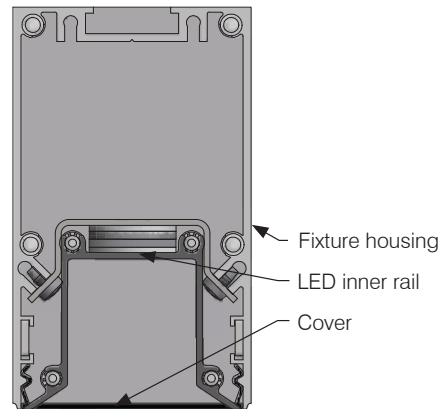

IMPORTANT SAFETY INSTRUCTIONS

KEEP THESE INSTALLATION INSTRUCTIONS

(Including General and Additional Markings for Fixtures)

(FOR MP LIGHTING LED LUMINAIRES, CLASS 3402-xx)

General and additional markings

1. For Use Only with Certified/NRTL Driver, Model _____
2. DRY LOCATIONS ONLY or OUTDOOR USE ONLY or DRY/
OUTDOOR USE ONLY or Outdoor / submersible Use Only - as
indicated on fixtures
3. MIN 90 C SUPPLY CONDUCTORS
4. Models L01, L03, L04, L05, L06, and L07: SUITABLE FOR USE IN
POURED CONCRETE, USE ON CLASS 2 CIRCUIT ONLY

Installation instructions

1. The grounding installation shall be done in accordance with
CEC-Part 1.
2. WARNING: RISK OF FIRE OR ELECTRIC SHOCK: DO NOT
MAKE OR ALTER ANY OPENINGS IN THE COMPARTMENT
OF WIRING OR ELECTRICAL COMPONENTS DURING
INSTALLATION. DO NOT ALTER OR ADD BALLASTS, OR ANY
OTHER ELECTRICAL COMPONENTS.
3. INSTALLATION AND USE OF THIS FIXTURE MOUNTING
ASSEMBLY REQUIRES A PERSON FAMILIAR WITH THE
CONSTRUCTION AND OPERATION OF LUMINAIRE
ELECTRICAL SYSTEMS AND THE HAZARD INVOLVED, IF NOT
QUALIFIED, DO NOT ATTEMPT INSTALLATION. CONTACT A
QUALIFIED ELECTRICIAN.
4. TURN OFF POWER BEFORE INSTALLATION.
5. KEEP THESE INSTALLATION INSTRUCTIONS.

CONSIGNES DE SÉCURITÉ IMPORTANTES

CONSERVER CES INSTRUCTIONS D'INSTALLATION

(Dont le général et marques supplémentaires pour les appareils)

(Pour les luminaires LED MP D'ÉCLAIRAGE , CLASS 3402 -xx)

Général et marquages supplémentaires

1. A utiliser uniquement avec Certified / NRTL pilote, modèle _____
2. POUR EMPLACEMENTS SECS SEULEMENT ou UTILISATION
EXTÉRIEURE SEULEMENT ou SEC / UTILISATION EXTÉRIEURE
SEULEMENT ou extérieure / Utilisation submersible seulement -
comme indiqué sur les appareils
3. LES FILS D'ALIMENTATION 90 °C MIN
4. Modèles L01, L03, L04, L05, L06, L07 et: utilisables dans le béton
coulé, UTILISATION DE CLASSE 2 CIRCUIT UNIQUEMENT

Les instructions d'installation

1. L'installation de mise à la terre doit être fait en conformité avec
CEC Partie 1.
2. AVERTISSEMENT : RISQUE D'INCENDIE OU
D'ÉLECTROCUTION : NE PAS FAIRE OU MODIFIER DES
OUVERTURES DANS LE COMPARTIMENT DE CÂBLAGE OU
DE COMPOSANTS ÉLECTRIQUES LORS DE L'INSTALLATION.
NE PAS MODIFIER OU AJOUTER DES BALLASTS, OU AUTRES
COMPOSANTS ÉLECTRIQUES
3. CE PRODUIT DOIT ÊTRE INSTALLÉ SELON LE CODE
D'INSTALLATION PERTINENT, PAR UNE PERSONNE QUI
CONNAÎT BIEN LE PRODUIT ET SON FONCTIONNEMENT
AINSI QUE LES RISQUES INHÉRENTS. CONSULTER UN
ÉLECTRICIEN QUALIFIÉ.
4. COUPER LE COURANT AVANT L'INSTALLATION.
5. CONSERVEZ CES INSTRUCTIONS.