

# L309

## INTERIOR

In-grade | For floor, ceilings, walls, and stairs

- Dry location

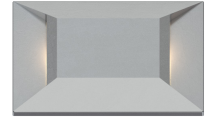
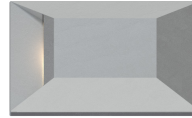

### Ordering Information

Clear Form

Date : \_\_\_\_\_

Quantity : \_\_\_\_\_

Project : \_\_\_\_\_

Note : \_\_\_\_\_

Type : \_\_\_\_\_

### Specifications

Luminaire | Example Code: L309-2-W30H-D-S6

Product	Version	CCT & CRI	Aperture	Trim Finish
L309				S6
	1 1W	W22S 2200K 80+	S single	<b>Stainless Steel Finish:</b> S6 stainless steel 316
	2 2W	W27H 2700K 90+	D double	
		W30H 3000K 90+		
		W35H 3500K 90+		
		W41H 4100K 90+		

### System Components (Ordered Separately)

Remote Driver : \_\_\_\_\_

Control System : \_\_\_\_\_

On/Off | Dimming ELV or 0-10 dimming  
Other options (consult factory) TRIAC/MLV, DMX, DALI, Casambi, PoE

### Important Notes

#### Warranty Notes & Disclaimer

Malfunction and damage to product due to incompatible dimming system or misuse will not be covered under warranty. Consult MP Lighting for recommended drivers. If the fixture has an option to be installed with a dimming control system, consult a dimming system manufacturer with minimum load before installing. MP Lighting reserves the right, at its sole discretion, at any time and without notice, to make design changes to any of our products. Consult MP Lighting website for most updated documentation.

# L309

## INTERIOR

In-grade | For floor, ceilings, walls, and stairs

● Dry location

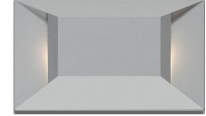
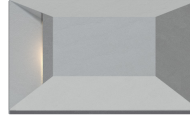

### Performance

Wattage	Forward Current	Power Consumption Budget per fixture (including driver)	LED output (Source)	Fixture Output (Delivered)
1W	350mA	1.3W	110 lm	0.1-0.2 lm
2W	700mA	2.6W	220 lm	0.2-1.1 lm

### Application

Environment	Dry Location approved. IP 40.
Mounting	Comes with steel flange that mounts to pre-installed standard 4" (102mm) octagonal back box (not included), 1-1/2"(38mm) deep minimum, and 1/4"(6mm) setback from face of finished surface material.

### Electrical

Power Supplies	Remote LED drivers (120-277V AC input, <b>constant current output</b> ): Fixtures to be wired in series.
Control	<b>On/off control   Dimming:</b> ELV or 0-10V dimming with appropriate drivers <b>Other options (consult factory):</b> TRIAC/MLV, DMX, DALI, Casambi, Power over Ethernet

### Luminaire Construction

LED Light Source	<b>W22S</b> = CCT: 2200K, CRI (Ra): 80+, Colour Consistency: 3SDCM <b>W27H</b> = CCT: 2700K, CRI (Ra): 90+, Colour Consistency: 2SDCM <b>W30H</b> = CCT: 3000K, CRI (Ra): 90+, Colour Consistency: 2SDCM <b>W35H</b> = CCT: 3500K, CRI (Ra): 90+, Colour Consistency: 2SDCM <b>W41H</b> = CCT: 4100K, CRI (Ra): 90+, Colour Consistency: 3SDCM
Standard Compliance	✓ADA-compliant ✓WELL standard – Feature 58: Color Quality
Weight	N/A
Material	<b>Fixture:</b> machined stainless steel (316)
Supplied with	<b>Standard installation housing:</b> Comes with a steel mounting flange.
Warranty & LED Life	5 years limited warranty Estimated useful life of LED is 50,000 hours.

### Ordered Separately

System Components	<b>Power supplies:</b> remote driver Please consult factory or visit <a href="#">Recommended Drivers</a> for available driver options..
-------------------	--

## Mounting Options & Dimensions

### LED Insert Dimensions

Fixture

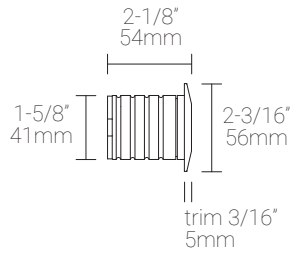

Top View

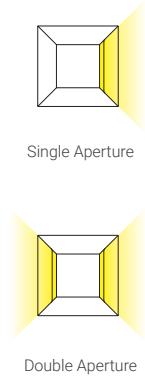

3D View (shown with double aperture)

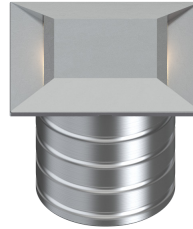

Beam

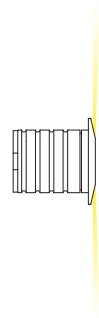

### Wall Installation (shown with a mounting flange)

Fixture with a mounting flange

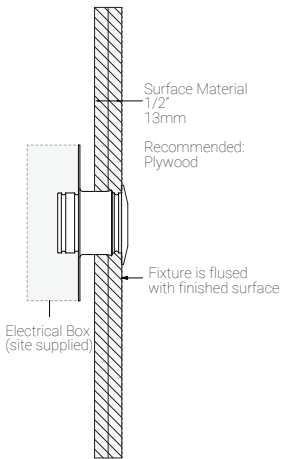

## Appendix

### Stainless Steel Finish

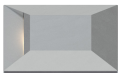

S6 stainless steel 316  
S single aperture

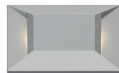

S6 stainless steel 316  
D double aperture

1W, 3000K, 90+ CRI

Isofootcandle Plot

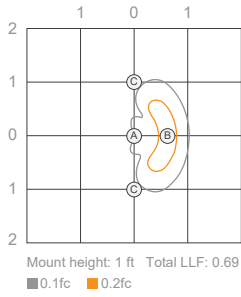

Illuminance at a Distance

Location	Center Beam fc
A	0.1fc
B	0.1fc
C	0.07fc

Delivered Lumen: 0.1 lm  
Tested on 24/09/2024

Isofootcandle Plot

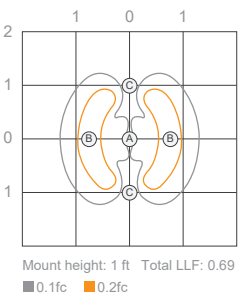

Illuminance at a Distance

Location	Center Beam fc
A	0.1fc
B	0.1fc
C	0.1fc

Delivered Lumen: 0.2 lm  
Tested on 24/09/2024

2W, 3000K, 90+ CRI

Isofootcandle Plot

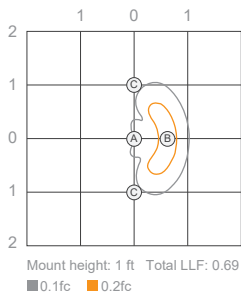

Illuminance at a Distance

Location	Center Beam fc
A	0.1fc
B	0.1fc
C	0.1fc

Delivered Lumen: 0.2 lm  
Tested on 24/09/2024

Isofootcandle Plot

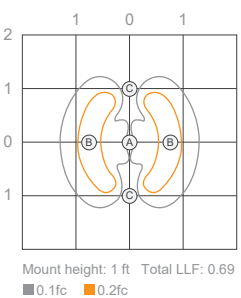

Illuminance at a Distance

Location	Center Beam fc
A	0.1fc
B	0.1fc
C	0.1fc

Delivered Lumen: 1.1 lm  
Tested on 24/09/2024