

PIPE-C-1

EXTERIOR

PVC Pipe | For landscaping

- Wet, Damp, and Dry location



Ordering Information

Clear Form

Date :	_____	Quantity :	_____
Project :	_____	Note :	_____
Type :	_____		_____

Specifications

PVC Pipe | Example Code: PIPE-C-1

Product ¹

PIPE-C-1

System Components (Ordered Separately)

Back Box : _____

* Please refer to Appendix for more information.

Important Notes

Specification

- Pipe for landscaping use.

Application

Environment	Dry / Damp / Wet Location approved.
Mounting	Designed to be mounted to electrical and/or landscape pipes. Field cuttable. Compatible with couplings, elbows, t-junction fittings for standard 1-1/2" PVC pipe (outer diameter 1-7/8", schedule 40, 80 and furniture grade pvc pipes.
Compatible Fixtures	In-grade: L01, L08, L300, L304, L312, L320 & L324. Spotlight: L930 B2 See pg.3 for product images of compatible fixtures. See pg.4-5 for application images of compatible fixtures.

Product Construction

Weight	NA
Material	Black PVC, UV stabilized

Mounting Options & Dimensions

Pipe Dimensions

Dimensions

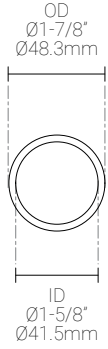

Length

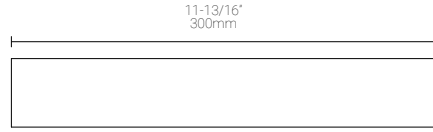

3D View



Installation (shown with L01)

Fixture (L01)

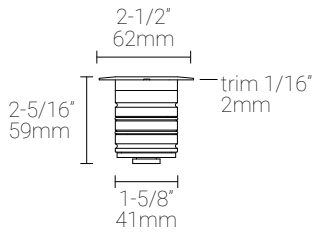

PIPE-C with L01

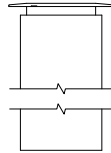

Compatible Fixtures

In-grade

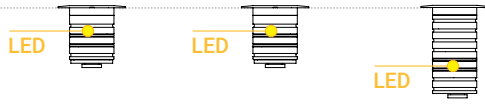

Regular Beam

L01 ●

L304 ●

L312 ●

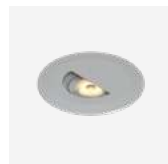

Half-Shielded

L300 ●



Single Aperture

L08-S ●

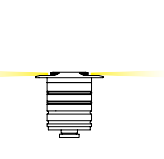

Double Aperture

L08-D ●

Spotlights

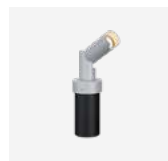

L930 with B2 ●
(Schedule 40 Pipe)

Shroud Options

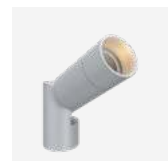

DS - Dry Location
Shroud

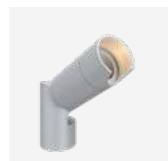

WS - Wet Location
Shroud

In-grade Installation

L01 | Landscape | During Installation



L01 | Landscape | Complete Installation



L01 | Stairs/Wall | During Installation



L01 | Stairs/Wall | Complete Installation



L01 | Stairs/Ground | During Installation



L01 | Stairs/Ground | Complete Installation



* Images will appear darker when printed.

Spotlight Installation

L930 B2 | Landscape | During Installation



L930 B2 | Landscape | Complete Installation



** Images will appear darker when printed.*