

# L133

EXTERIOR | INTERIOR

Surface Mount Downlight | For ceilings, counters & cabinets

○ Damp and Dry location | ● Photocell | ○ Motion Sensor

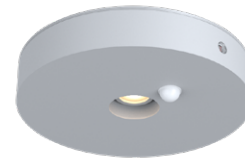

## Ordering Information

Clear Form

Date : \_\_\_\_\_ Quantity : \_\_\_\_\_

Project : \_\_\_\_\_ Note : \_\_\_\_\_

Type : \_\_\_\_\_

## Specifications

Luminaire | Example Code: L133-4-P-W30H-S-B-MA

| Product | Version | Sensor <sup>1</sup>                                     | CCT & CRI <sup>2</sup>   | Beam Angle                       | Surface-mount Box <sup>3</sup><br>(optional) | Finish                  |
|---------|---------|---|--|----------------------------------|--|-------------------------|
| L133    | 4       |   |  |                                  |  | MA                      |
|         | 4 4W    | P photocell sensor<br>M motion sensor<br>B both sensors | W22S 2200K 80+<br>W27H 2700K 90+<br>W30H 3000K 90+<br>W35H 3500K 90+ | S spot 12°<br>N narrow flood 30° | B surface-mount box                          | MA matte clear anodized |

## Important Notes

### Specification

1. Photocell sensor hole will be always on the housing whether the fixture uses it or not.
2. Refer to pg.02 - for Light Quality & Colour Consistency details.
3. Refer to pg.03-04 - for images and installation guide.

### Warranty Notes & Disclaimer

Malfunction and damage to product due to incompatible dimming system or misuse will not be covered under warranty. Consult MP Lighting for recommended drivers. If the fixture has an option to be installed with a dimming control system, consult a dimming system manufacturer with minimum load before installing. MP Lighting reserves the right, at its sole discretion, at any time and without notice, to make design changes to any of our products. Consult MP Lighting website for most updated documentation.

# L133

EXTERIOR | INTERIOR

Surface Mount Downlight | For ceilings, counters & cabinets

○ Damp and Dry location | ● Photocell | ○ Motion Sensor

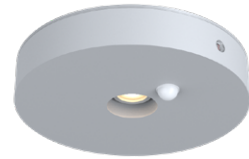

RoHS

## Performance

| Wattage | Forward Current | Power Consumption Budget per fixture (including driver) | LED output (Source) | Fixture Output (Delivered) |
|---------|-----------------|---|---------------------|----------------------------|
| 4W      | 350mA           | 4W  | 440 lm              | 208-261 lm                 |

## Application

|             |  |
|-------------|--|
| Environment | Damp and Dry Location approved. IP 62.   |
| Mounting    | Mounts with built-in surface-mount box (optional) or mounts to a 4" octagonal box (supplied by others) |

## Electrical

|            |  |
|------------|--|
| Electrical | Integral LED drivers (120V AC input, non-dimmable, <b>constant voltage output</b> ). |
| Control    | <b>On/off control</b>  |

## Luminaire Construction

|                     |   |
|---------------------|---|
| LED Light Source    | <b>W22S</b> = CCT: 2200K, CRI (Ra): 80+, Colour Consistency: 3SDCM<br><b>W27H</b> = CCT: 2700K, CRI (Ra): 90+, Colour Consistency: 2SDCM<br><b>W30H</b> = CCT: 3000K, CRI (Ra): 90+, Colour Consistency: 2SDCM<br><b>W35H</b> = CCT: 3500K, CRI (Ra): 90+, Colour Consistency: 3SDCM (Contact factory for 2SDCM option) |
| Weight              | N/A   |
| Material            | <b>Fixture:</b> machined marine-grade aluminum  |
| Supplied with       | <b>Standard installation housing:</b> Comes with an adapter plate, two #8-32 screws, and wire nuts OR with the optional Surface mount back box (B).   |
| Warranty & LED Life | 5 years limited warranty<br>Estimated useful life of LED is 50,000 hours.   |

Mounting Options & Dimensions

LED Fixture Dimensions

Fixture

Top View

3D View

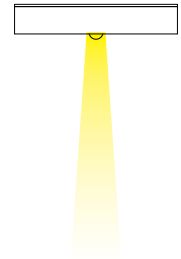
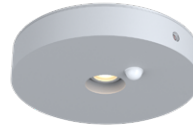
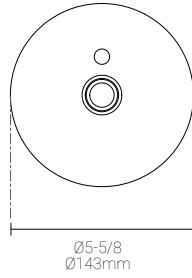
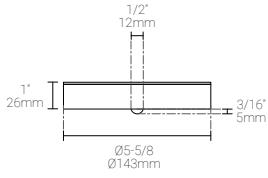

LED Fixture Dimensions | with B, surface-mount box

Fixture

Bottom View

3D View

Beam

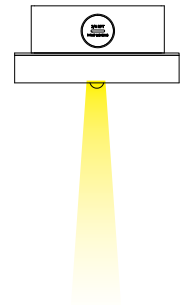
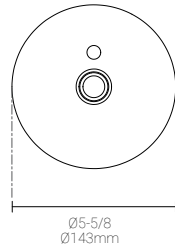
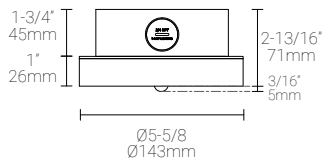

Mounting Options & Dimensions

Installation with standard 4" octagonal back box (supplied by others)

Fixture

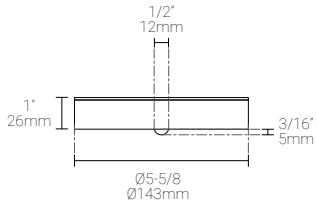

Ceiling mounted

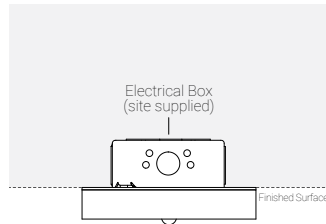

LED Fixture Dimensions | with B, surface-mount box

Fixture

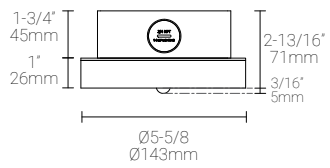

Ceiling mounted

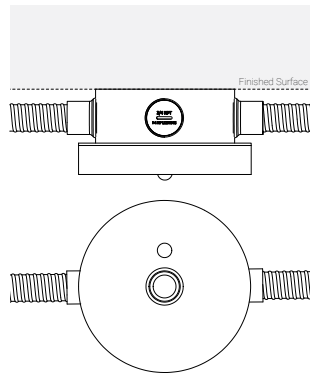

Polar Candela Distribution

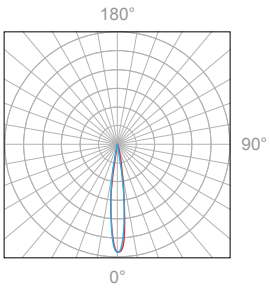

Beam Width: 12°

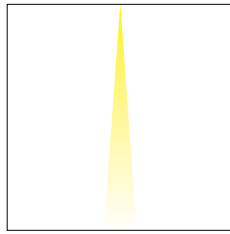

Illuminance at a Distance

| Distance |       | Center Beam fc | Beam Width |       |       |       |
|----------|-------|----------------|------------|-------|-------|-------|
| 3.0ft    | 0.91m | 359fc          | 0.8ft      | 0.24m | 0.8ft | 0.24m |
| 6.0ft    | 1.83m | 89.8fc         | 1.5ft      | 0.46m | 1.5ft | 0.46m |
| 9.0ft    | 2.74m | 39.9fc         | 2.3ft      | 0.70m | 2.3ft | 0.70m |
| 12.0ft   | 3.66m | 22.5fc         | 3.0ft      | 0.91m | 3.0ft | 0.91m |
| 15.0ft   | 4.57m | 14.4fc         | 3.8ft      | 1.16m | 3.8ft | 1.16m |
| 18.0ft   | 5.49m | 9.98fc         | 4.5ft      | 1.37m | 4.5ft | 1.37m |

Delivered Lumen: 283.7lm  
 ■ Vertical Beam Spread: 14.4°  
 ■ Horizontal Beam Spread: 14.3°

Polar Candela Distribution

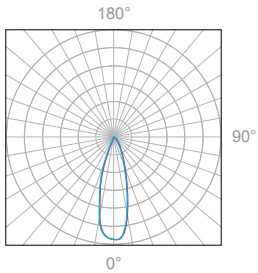

Beam Width: 30°

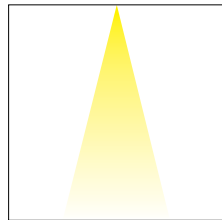

Illuminance at a Distance

| Distance |       | Center Beam fc | Beam Width |       |       |       |
|----------|-------|----------------|------------|-------|-------|-------|
| 3.0ft    | 0.91m | 148fc          | 1.4ft      | 0.43m | 1.4ft | 0.43m |
| 6.0ft    | 1.83m | 37.1fc         | 2.8ft      | 0.85m | 2.7ft | 0.88m |
| 9.0ft    | 2.74m | 16.5fc         | 4.1ft      | 1.25m | 4.1ft | 1.25m |
| 12.0ft   | 3.66m | 9.72fc         | 5.5ft      | 1.68m | 5.5ft | 1.68m |
| 15.0ft   | 4.57m | 5.93fc         | 6.9ft      | 2.10m | 6.9ft | 2.10m |
| 18.0ft   | 5.49m | 4.12fc         | 8.3ft      | 2.53m | 8.6ft | 2.50m |

Delivered Lumen: 273.8lm  
 ■ Vertical Beam Spread: 25.9°  
 ■ Horizontal Beam Spread: 25.8°