



LED Driver Enclosures

# EBX-160-ZP

## SPEC SHEET

---

- Usage:** LED driver enclosures.
- Material:** Zinc plated
- Unit Package:** 1 unit.
- Approval:** Dry locations.

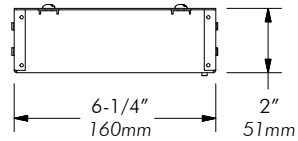
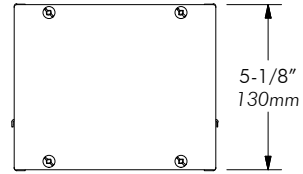

CODE

**EBX-160-ZP**

[ Project ]

[ Quantity ]

[ Notes ]

