

END101

INTERIOR

One Circuit Track Hardware - End Cap

● Dry location



Ordering Information

Clear Form

Date : _____

Quantity : _____

Project : _____

Note : _____

Type : _____

Specifications

End Cap | Example Code: END101-BK

Product	Finish ¹
END101	BK black WH white

Important Notes

Specification

1. Refer to Appendix or MP Lighting website for track system with different finish options.

Application

Environment	Dry Location approved. IP 20.
Mounting	Surface mounting or suspension mounting.
Compatible Fixtures	12V: L225M (4W & 8W) 48V: L225S (1W & 2W), L225M (4W & 8W), L225L (13W), L199 (4W & 8W), L698 (4W & 8W), and P96S-LED (8W).

Electrical

Electrical	Low Voltage 1 Circuit Track: 60W/12V 96W/48V Compatible Drivers 12V: 0-10V, ELV dimmable. 48V: 0-10V, DALI dimmable
------------	---

Construction

Weight	N/A
Material	Polycarbonate.

Mounting Options & Dimensions

Dimensions

Side View

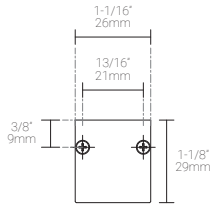

Top View

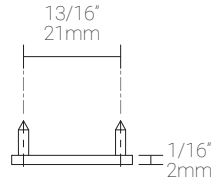

3D View



1CT Track | All 1CT fixtures comes with Track Adapter

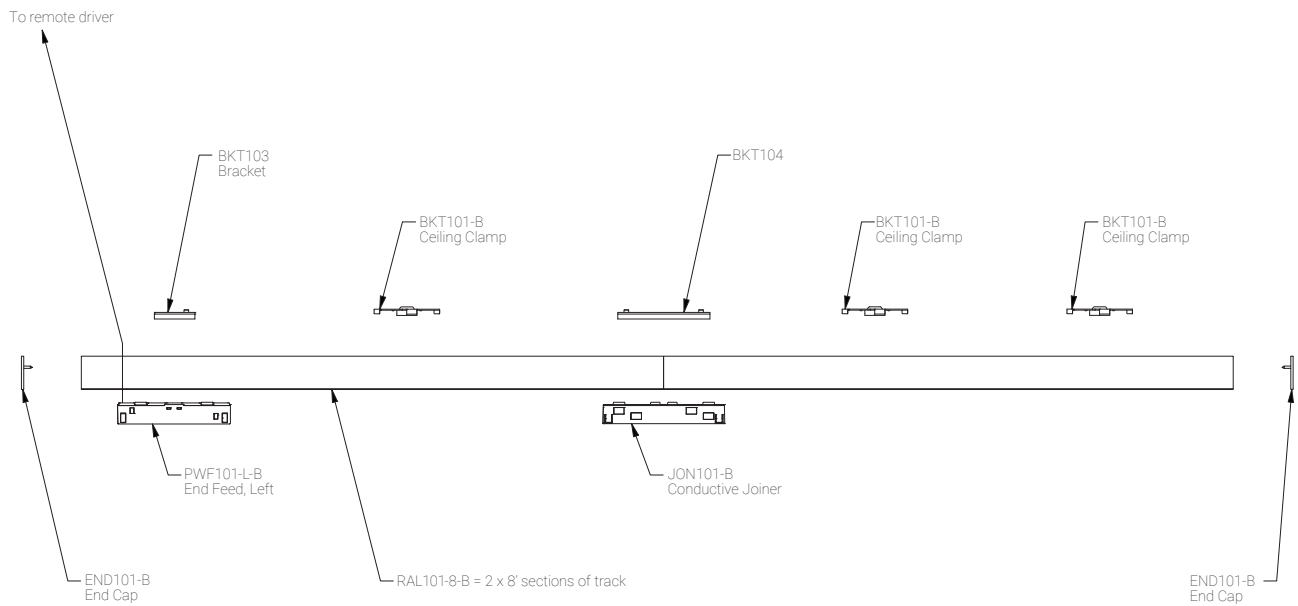
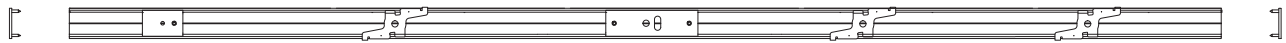

Appendix

Aluminum Finishes



BK black



WH white