

L153

Linear Landscape

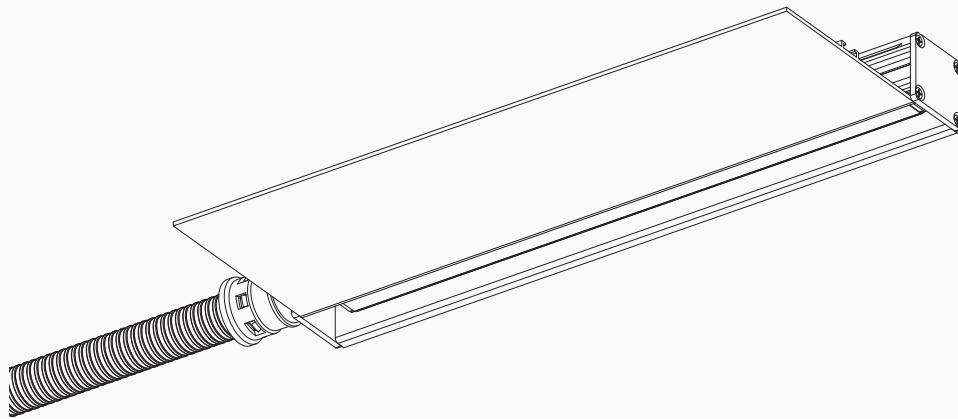

L153

Linear Landscape

Parts

- LED fixture x 1
- Outer concrete mount extrusion x 1
- IP68 wire connector x 1
- Remote LED driver x 1

Concrete pour stairs

- 1) Once first pour is completed determine desired location for each fixture.

*Fixture can be secured into place by drilling screws through the flat plate on one side of the outer concrete mount extrusion.

- 2) Prepare forms for second concrete pour, ensure the inside of outer concrete mount extrusion stays clean and free from concrete. Install wiring and conduit before second concrete pour.

- 3) When concrete is cured and forms are removed connect fixture wires to remote driver using IP68 waterproof wire connector.

- 4) Insert LED fixture into outer concrete mount extrusion securing with one mounting screw on each endcap.

*Power to remote driver must be off while wiring LED fixture to driver.

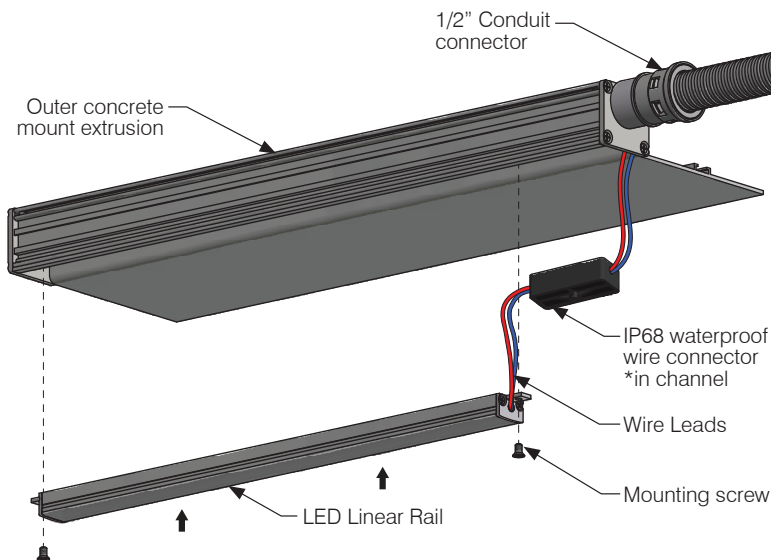

IP68 Wire Connector

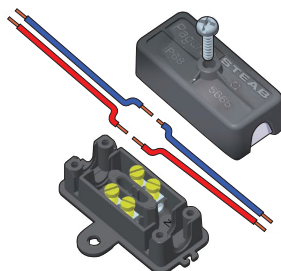

**Clean with a soft non-abrasive cloth. Never use any chemical cleaning products. Do not spray water directly at fixture or pressure wash.

First pour

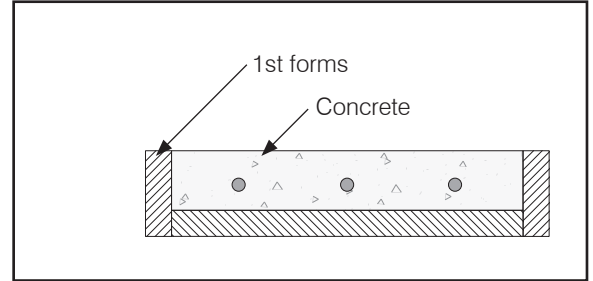

Preparation for second pour

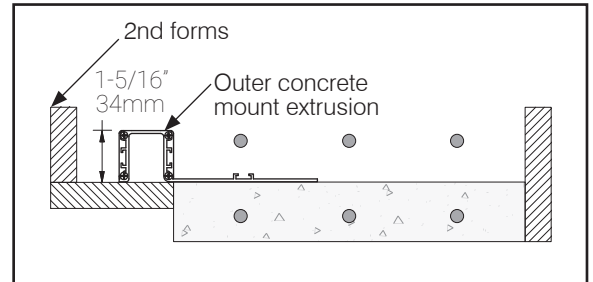

Finished result after second pour

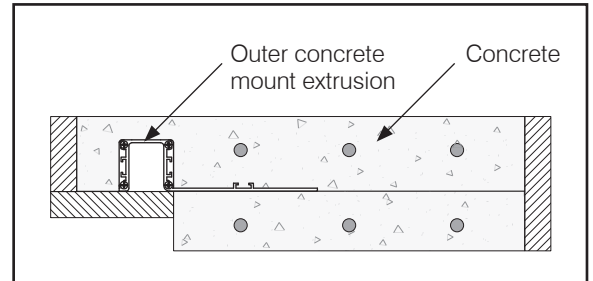

Finished product after forms removed

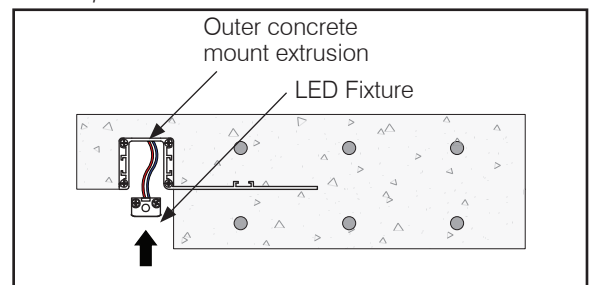

LED fixture installed

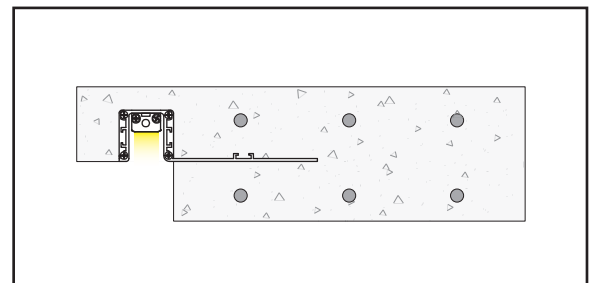

L153

Linear Landscape

