

L224

INTERIOR

Spotlights | For ceilings, walls

● Dry location

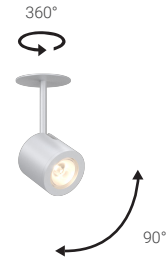

Ordering Information

Clear Form

Date : _____

Quantity : _____

Project : _____

Note : _____

Type : _____

Specifications

Luminaire | Example Code: L224-C3-M-8-W30H-W-2-MA

Product	Canopy ¹	Size	Version	CCT & CRI	Beam Angle	Stem Length ²	Finish ³				
L224		M									
C1	M medium	4 4W	W27H 2700K 90+	S spot 12°	2 2" (51mm)	Aluminum Finishes:	MA matte clear anodized				
C3							8 8W	W30H 3000K 90+	N narrow flood 30°	X custom length	BA black anodized
C4									F flood 60°		WH white powder coated
C21									W wide flood 100°		
C23											

System Components (Ordered Separately)

Remote Driver : _____

* Consult MP Lighting Website or Factory.

Important Notes

Specification

- See pg.3 - for different canopy options and its dimensions.
- 1" (25mm) increments to maximum of 8' (2438mm). Minimum 4" (102mm) stem for C23 canopy.
- Refer to Appendix or MP Lighting website for complete look of luminaire with different finish options. Please consult factory for custom finish for shrouds. WH not available with Super Spot beam angle.

Warranty Notes & Disclaimer

Malfunction and damage to product due to incompatible dimming system or misuse will not be covered under warranty. Consult MP Lighting for recommended drivers. If the fixture has an option to be installed with a dimming control system, consult a dimming system manufacturer with minimum load before installing. MP Lighting reserves the right, at its sole discretion, at any time and without notice, to make design changes to any of our products. Consult MP Lighting website for most updated documentation.

L224

INTERIOR

Spotlights | For ceilings, walls

● Dry location

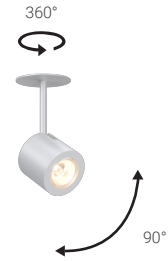

Performance

Wattage	Forward Current	Power Consumption Budget per fixture (including driver)	LED output (Source)	Fixture Output (Delivered)
4W	350mA	4W	440 lm	185.5-377 lm
8W	700mA	8W	880 lm	319.5-655 lm

Application

Environment	Dry Location approved. IP 20.
Mounting	Mounts to a 4" octagonal box using the mounting canopy.

Electrical

Power Supplies	Remote LED drivers (120-277V AC input, constant current output): Fixtures to be wired in series.
Control	On/off control Dimming: ELV or 0-10V dimming with appropriate drivers Other options (consult factory): TRIAC/MLV, DMX, DALI, Casambi, Power over Ethernet

Luminaire Construction

LED Light Source	Colour Consistency: 2-step MacAdam: 2700K, 3000K, 90+ CRI
Weight	N/A
Material	Fixture: machined marine-grade aluminum
Supplied with	Standard installation housing: Comes with a canopy, a universal crossbar, two hex socket head screws, two wire-nuts, and an allen key.
Warranty & LED Life	5 years limited warranty Estimated useful life of LED is 50,000 hours.

Ordered Separately

System Components	Power supplies: remote driver Please consult factory or visit Recommended Drivers for available driver options.
-------------------	---

Mounting Options & Dimensions

LED Fixture Dimensions (shown with C21 canopy)

Fixture

Front View

3D View

Beam

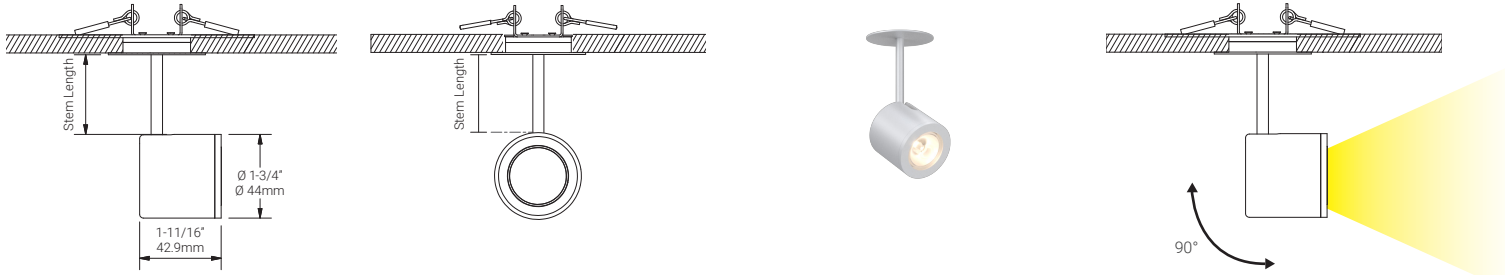

Measurement of Custom Stem Length (X)

C1

C3

C4

C21

C23

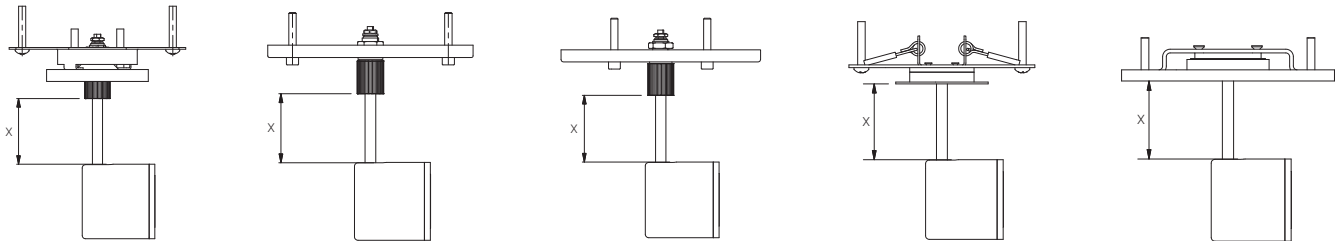

* Spotlight can rotate 360° with C21 canopy.

* Spotlight can rotate 360° with C23 canopy.

Mounting Options & Dimensions

C1

Canopy



Fixture with Canopy



Dimensions

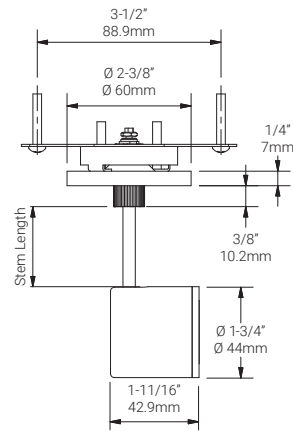

C3

Canopy



Fixture with Canopy



Dimensions

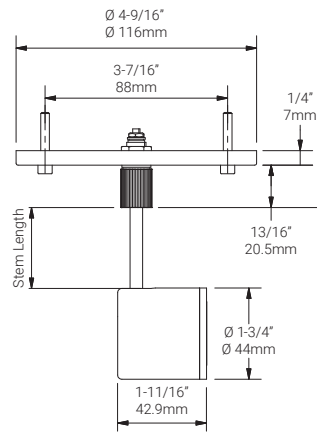

C4

Canopy

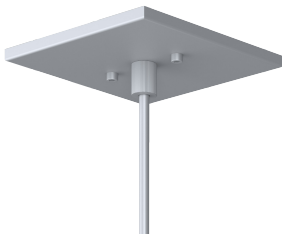

Fixture with Canopy



Dimensions

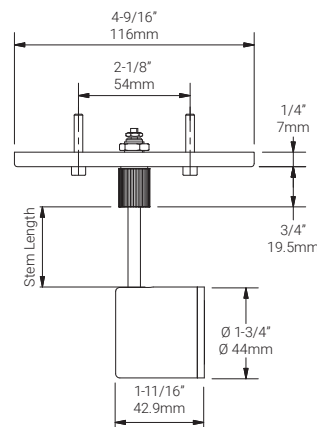

Mounting Options & Dimensions

C21

Canopy



Fixture with Canopy



Dimensions

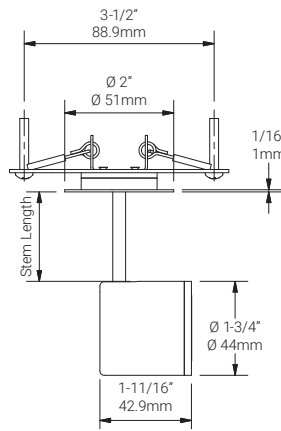

Dimensions (Spring Clips)

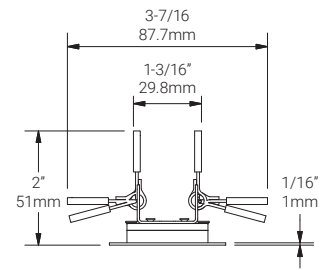

* Spotlight can rotate 360° with C21 canopy.

C23

Canopy



Fixture with Canopy



Dimensions

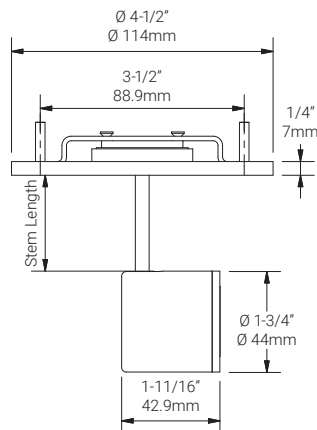

* Spotlight can rotate 360° with C23 canopy.

Appendix

Aluminum Finishes



MA matte clear anodized



BA black anodized



WH white powder coated

4W, 3000K, 90+ CRI

Polar Candela Distribution

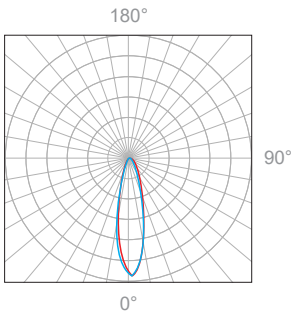

Beam Width: 12°



Illuminance at a Distance

Distance		Center Beam fc	Beam Width			
1.0ft	0.30m	1447fc	0.4ft	0.12m	0.4ft	0.12m
2.0ft	0.61m	362fc	0.8ft	0.24m	0.8ft	0.24m
3.0ft	0.91m	161fc	1.2ft	0.36m	1.2ft	0.36m
4.0ft	1.22m	90.4fc	1.6ft	0.48m	1.6ft	0.48m
5.0ft	1.52m	57.9fc	2.0ft	0.61m	2.0ft	0.61m
6.0ft	1.83m	40.2fc	2.4ft	0.73m	2.4ft	0.73m

Delivered Lumen: 377.2 lm
 ■ Vertical Beam Spread: 22.6°
 ■ Horizontal Beam Spread: 22.6°

Polar Candela Distribution

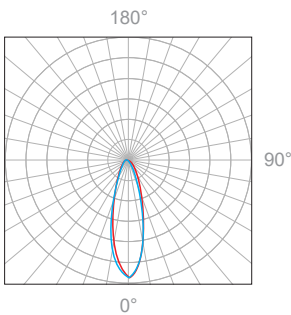

Beam Width: 30°



Illuminance at a Distance

Distance		Center Beam fc	Beam Width			
1.0ft	0.30m	875fc	0.6ft	0.18m	0.6ft	0.18m
2.0ft	0.61m	219fc	1.1ft	0.32m	1.1ft	0.32m
3.0ft	0.91m	97.2fc	1.7ft	0.51m	1.7ft	0.51m
4.0ft	1.22m	54.7fc	2.2ft	0.67m	2.2ft	0.67m
5.0ft	1.52m	35.0fc	2.8ft	0.73m	2.8ft	0.73m
6.0ft	1.83m	24.3fc	3.3ft	1.00m	3.4ft	1.03m

Delivered Lumen: 351.4 lm
 ■ Vertical Beam Spread: 30.9°
 ■ Horizontal Beam Spread: 31.2°

Polar Candela Distribution

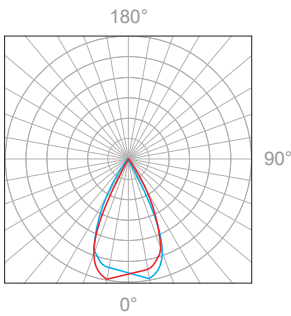

Beam Width: 60°

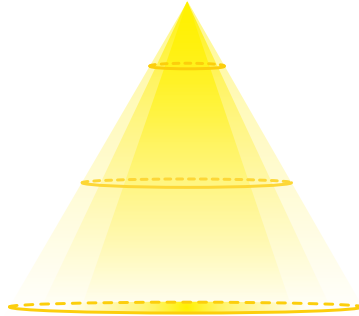

Illuminance at a Distance

Distance		Center Beam fc	Beam Width			
1.0ft	0.30m	368fc	0.9ft	0.27m	1.0ft	0.30m
2.0ft	0.61m	92.0fc	1.8ft	0.54m	2.0ft	0.61m
3.0ft	0.91m	40.9fc	2.7ft	0.82m	3.0ft	0.91m
4.0ft	1.22m	23.0fc	3.7ft	1.12m	4.0ft	1.22m
5.0ft	1.52m	14.7fc	4.6ft	1.40m	5.0ft	1.52m
6.0ft	1.83m	10.2fc	5.5ft	1.67m	6.0ft	1.83m

Delivered Lumen: 318.9 lm
 ■ Vertical Beam Spread: 49.1°
 ■ Horizontal Beam Spread: 52.9°

Polar Candela Distribution

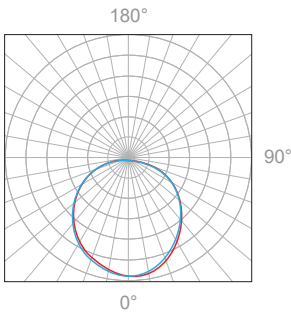

Beam Width: 100°

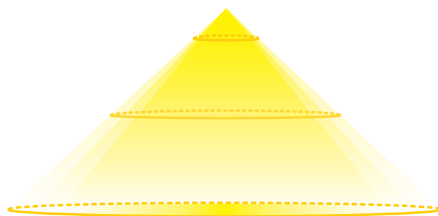

Illuminance at a Distance

Distance		Center Beam fc	Beam Width			
1.0ft	0.30m	67.5fc	2.6ft	0.79m	2.6ft	0.79m
2.0ft	0.61m	16.9fc	5.3ft	1.61m	5.1ft	1.55m
3.0ft	0.91m	7.50fc	7.9ft	2.40m	7.7ft	1.34m
4.0ft	1.22m	4.22fc	10.6ft	3.23m	10.3ft	3.14m
5.0ft	1.52m	2.70fc	13.2ft	4.02m	12.8ft	3.90m
6.0ft	1.83m	1.88fc	15.8ft	4.81m	15.4ft	4.69m

Delivered Lumen: 185.5 lm
 ■ Vertical Beam Spread: 105.7°
 ■ Horizontal Beam Spread: 104.2°

8W, 3000K, 90+ CRI

Polar Candela Distribution

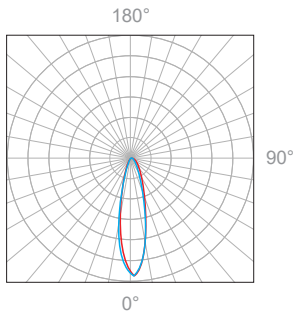

Beam Width: 12°



Illuminance at a Distance

Distance		Center Beam fc	Beam Width			
1.0ft	0.30m	2526fc	0.4ft	0.12m	0.4ft	0.12m
2.0ft	0.61m	631fc	0.8ft	0.24m	0.8ft	0.24m
3.0ft	0.91m	281fc	1.2ft	0.36m	1.2ft	0.36m
4.0ft	1.22m	158fc	1.6ft	0.48m	1.6ft	0.48m
5.0ft	1.52m	101fc	2.0ft	0.61m	1.9ft	0.58m
6.0ft	1.83m	70.2fc	2.4ft	0.73m	2.3ft	0.70m

Delivered Lumen: 655.8 lm
 ■ Vertical Beam Spread: 22.5°
 ■ Horizontal Beam Spread: 21.9°

Polar Candela Distribution

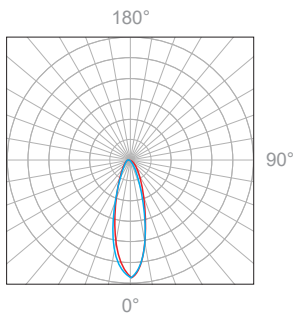

Beam Width: 30°

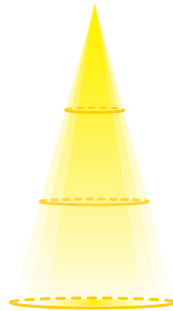

Illuminance at a Distance

Distance		Center Beam fc	Beam Width			
1.0ft	0.30m	1521fc	0.6ft	0.18m	0.5ft	0.15m
2.0ft	0.61m	380fc	1.1ft	0.32m	1.1ft	0.32m
3.0ft	0.91m	169fc	1.7ft	0.51m	1.6ft	0.48m
4.0ft	1.22m	95.1fc	2.2ft	0.67m	2.2ft	0.67m
5.0ft	1.52m	60.8fc	2.8ft	0.73m	2.7ft	0.70m
6.0ft	1.83m	42.3fc	3.3ft	1.00m	3.3ft	1.00m

Delivered Lumen: 602.3 lm
 ■ Vertical Beam Spread: 30.9°
 ■ Horizontal Beam Spread: 30.3°

Polar Candela Distribution

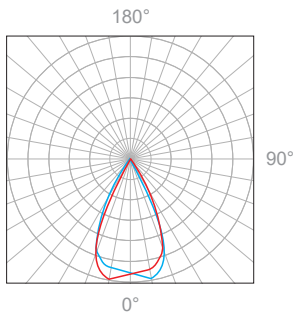

Beam Width: 60°

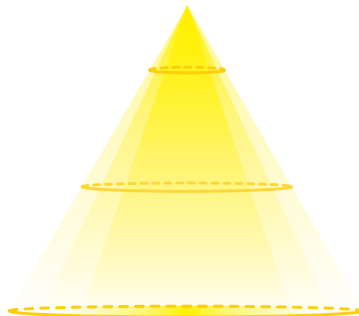

Illuminance at a Distance

Distance		Center Beam fc	Beam Width			
1.0ft	0.30m	611fc	0.9ft	0.27m	1.0ft	0.30m
2.0ft	0.61m	153fc	1.8ft	0.54m	2.0ft	0.61m
3.0ft	0.91m	67.9fc	2.7ft	0.82m	3.0ft	0.91m
4.0ft	1.22m	38.2fc	3.6ft	1.09m	4.0ft	1.22m
5.0ft	1.52m	24.4fc	4.5ft	1.37m	5.0ft	1.52m
6.0ft	1.83m	17.0fc	5.4ft	1.67m	6.0ft	1.83m

Delivered Lumen: 544.5 lm
 ■ Vertical Beam Spread: 48.4°
 ■ Horizontal Beam Spread: 52.9°

Polar Candela Distribution

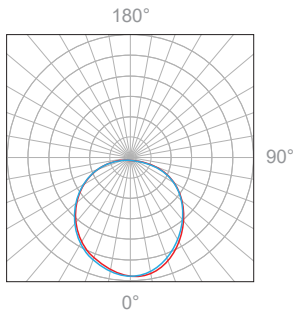

Beam Width: 100°

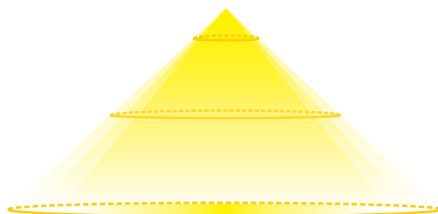

Illuminance at a Distance

Distance		Center Beam fc	Beam Width			
1.0ft	0.30m	117fc	2.6ft	0.79m	2.5ft	0.76m
2.0ft	0.61m	29.3fc	5.2ft	1.58m	5.1ft	1.55m
3.0ft	0.91m	13.0fc	7.8ft	2.37m	7.6ft	1.31m
4.0ft	1.22m	7.34fc	10.4ft	3.17m	10.2ft	3.11m
5.0ft	1.52m	4.69fc	13.0ft	3.96m	12.7ft	3.87m
6.0ft	1.83m	3.26fc	15.7ft	4.78m	15.3ft	4.66m

Delivered Lumen: 319.5 lm
 ■ Vertical Beam Spread: 105.1°
 ■ Horizontal Beam Spread: 103.6°