

L650L

INTERIOR

Suspended Linear Pendant | For ceilings

● Dry location

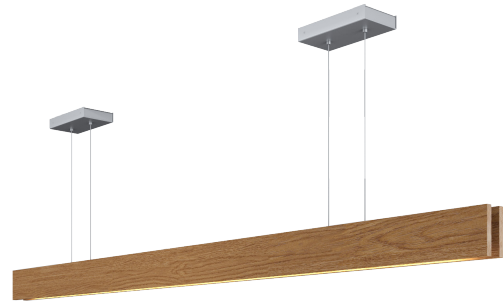

Ordering Information

Clear Form

Date : _____

Quantity : _____

Project : _____

Note : _____

Type : _____

Specifications

Luminaire | Example Code: L650L-C10-10-8-W30H-W-P-C72-WO-I

Product	Mounting	Version	Fixture Length	CCT & CRI	Beam Angle	Lens	Cord Length ¹	Material (Wood)	Finish ² (optional)
L650L	C10	10	8		W			WO	
	C10 rectangular canopy	10 10W/ft	8 8' (2.4m) light source, 8.5' (2.6m) wood cover	W22S 2200K 80+ W27H 2700K 90+ W30H 3000K 90+ W35H 3500K 90+ W41H 4100K 90+	W wide flood 120°	F frosted P prismatic	C72 72" (1830mm) CX custom length	WO white oak	I intumescent fire retardant coating

System Components (Ordered Separately)

Remote Driver : LED100W24VP-01B

Control System : _____

On/Off | Dimming ELV dimming
Other options (consult factory) TRIAC/MLV, DMX, DALI, Casambi, PoE

Important Notes

Specification

- Minimum: 1' (305mm) Maximum: 8' (2438mm), 6" (152.4mm) increments.
- Intumescent fire retardant coating applied to pendant against high humidity and other potentially harsh environmental conditions.

Warranty Notes & Disclaimer

Malfunction and damage to product due to incompatible dimming system or misuse will not be covered under warranty. Consult MP Lighting for recommended drivers. If the fixture has an option to be installed with a dimming control system, consult a dimming system manufacturer with minimum load before installing. MP Lighting reserves the right, at its sole discretion, at any time and without notice, to make design changes to any of our products. Consult MP Lighting website for most updated documentation.

L650L

INTERIOR

Suspended Linear Pendant | For ceilings

● Dry location

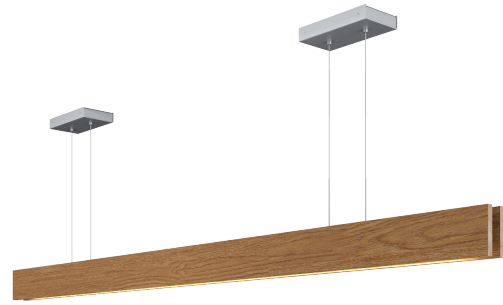

Performance

Wattage	Output Voltage	Power Consumption Budget per fixture (including driver)	LED output (Source)	Fixture Output (Delivered)
10W/ft	24V	13.5W/ft	1100 lm/ft	496-637 lm/ft

Application

Environment	Dry Location approved. IP20
Mounting	C10 X 2: Mounts to a 4" octagonal box using the mounting canopy.

Electrical

Power Supplies	Remote LED drivers (120-277V AC input, constant voltage output): Fixtures to be wired in parallel. Included: LED100W24VP-01B (120V AC input, ELV Dim).
Control	On/off control Dimming: ELV or 0-10V dimming with appropriate drivers Other options (consult factory): TRIAC/MLV, DMX, DALI, Casambi, Power over Ethernet

Luminaire Construction

LED Light Source	W22S = CCT: 2200K, CRI (Ra): 80+, Colour Consistency: 3SDCM W27H = CCT: 2700K, CRI (Ra): 90+, Colour Consistency: 3SDCM W30H = CCT: 3000K, CRI (Ra): 90+, Colour Consistency: 3SDCM W35H = CCT: 3500K, CRI (Ra): 90+, Colour Consistency: 3SDCM W41H = CCT: 4100K, CRI (Ra): 90+, Colour Consistency: 3SDCM
Standard Compliance	✓ WELL standard – Feature 58: Color Quality
Weight	N/A
Material	Fixture Interior: PMMA Fixture Exterior: White Oak
Supplied with	Standard installation housing: Comes with a canopy Cable: 3' (914mm) factory-installed wire lead
Warranty & LED Life	5 years limited warranty Estimated useful life of LED is 50,000 hours.

Ordered Separately

System Components	Power supplies: remote driver Please consult factory or visit Recommended Drivers for available driver options.
-------------------	---

Mounting Options & Dimensions

LED Fixture Dimensions

Front View

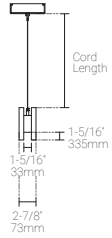

Side, Top, Bottom View

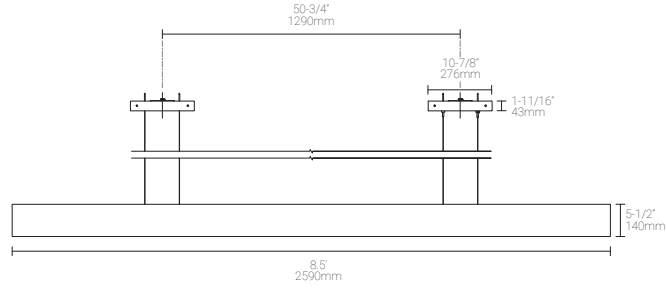

3D View

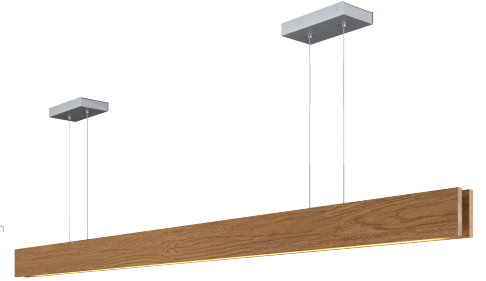

L650M Top View



L650M Bottom View

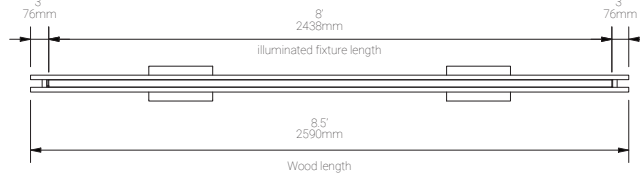

10W, 1' (305mm), 3000K, 90+ CRI

Frosted Lens

Polar Candela Distribution

Beam Width: 120°

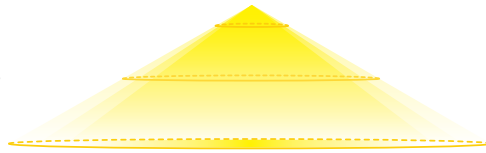
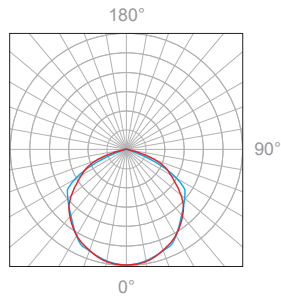

Illuminance at a Distance

Distance		Center Beam fc	Beam Width			
3.0ft	0.91m	39.96fc	10.6ft	3.23m	9.5ft	2.89m
6.0ft	1.83m	10.26fc	21.3ft	6.50m	19.1ft	5.82m
9.0ft	2.74m	4.75fc	31.9ft	9.72m	28.6ft	8.72m
12.0ft	3.66m	2.81fc	42.5ft	12.95m	38.2ft	11.64m
15.0ft	4.57m	1.84fc	53.2ft	16.21m	47.7ft	14.54m
18.0ft	5.49m	1.30fc	63.8ft	19.45m	57.3ft	17.47m

Delivered Lumen: 352lm

■ Vertical Beam Spread : 121.1°
■ Horizontal Beam Spread : 115.7°

Prismatic Lens

Polar Candela Distribution

Beam Width: 120°

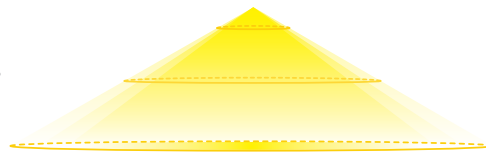
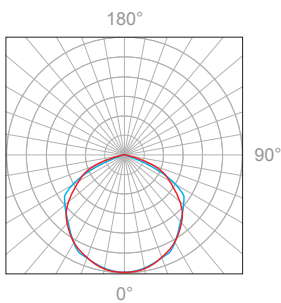

Illuminance at a Distance

Distance		Center Beam fc	Beam Width			
3.0ft	0.91m	59.41fc	10.3ft	3.14m	9.6ft	2.93m
6.0ft	1.83m	15.12fc	20.7ft	6.31m	19.2ft	5.85m
9.0ft	2.74m	6.91fc	31ft	9.45m	28.8ft	8.78m
12.0ft	3.66m	4.10fc	41.4ft	12.62m	38.4ft	11.70m
15.0ft	4.57m	2.70fc	51.7ft	15.76m	48ft	14.63m
18.0ft	5.49m	1.94fc	62ft	18.90m	57.6ft	17.56m

Delivered Lumen: 434.2lm

■ Vertical Beam Spread : 119.7°
■ Horizontal Beam Spread : 116°

Full Spectrum

— Full Spectrum — Standard Illuminant @ 3000K — Ra≥80

