

L91

EXTERIOR | INTERIOR

Wall-mount | For walls, up or down illumination.

- Wet, Damp, and Dry location



Ordering Information

Clear Form

Date : _____ Quantity : _____

Project : _____ Note : _____

Type : _____

Specifications

Luminaire | Example Code: L91-2-W30H-S-C-0-MA

Product	Version	CCT & CRI ¹	Beam Angle	Lens	Internal Angle Bracket ²	Trim Finish ³
L91	2					
	2 2W	W22S 2200K 80+ W27H 2700K 90+ W30H 3000K 90+ W35H 3500K 90+ W41H 4100K 90+	S spot 12° N narrow flood 30° F flood 45° W wide flood 120°	C clear F frosted	0 no angle 30 30° angle X custom	Aluminum Finishes: MA matte clear anodized BA black anodized

System Components (Ordered Separately)

Remote Driver : _____

* Consult MP Lighting Website or Factory.

Important Notes

Specifications

- Refer to pg.2 - for Light quality and colour consistency details.
- Maximum Angle: 30°
- Refer to Appendix or MP Lighting website for complete look of luminaire with different finish options.

Warranty Notes & Disclaimer

Malfunction and damage to product due to incompatible dimming system or misuse will not be covered under warranty. Consult MP Lighting for recommended drivers. If the fixture has an option to be installed with a dimming control system, consult a dimming system manufacturer with minimum load before installing. MP Lighting reserves the right, at its sole discretion, at any time and without notice, to make design changes to any of our products. Consult MP Lighting website for most updated documentation.

L91

EXTERIOR | INTERIOR

Wall-mount | For walls, up or down illumination.

- Wet, Damp, and Dry location



Performance

Wattage	Forward Current	Power Consumption Budget per fixture (including driver)	LED output (Source)	Fixture Output (Delivered)
2W	700mA	3W	220 lm	34-110 lm

Application

Environment	Dry / Damp / Wet Location approved. IP 66.
Mounting	Mounts to standard 4" (102mm) octagonal box with 1-1/2" (38mm) minimum depth. Can be positioned facing up or down.

Electrical

Power Supplies	Non-dimmable integral driver included (100-240V AC input).
Control	<p>On/off control</p> <p>Dimming(consult factory): 0-10V dimming with appropriate dimming controller (ordered separately).</p> <p>Other options (consult factory): TRIAC/MLV, DMX, DALI, Casambi, Power over Ethernet</p>

Luminaire Construction

LED Light Source	<p>W22S = CCT: 2200K, CRI (Ra): 80+, Colour Consistency: 3SDCM</p> <p>W27H = CCT: 2700K, CRI (Ra): 90+, Colour Consistency: 2SDCM</p> <p>W30H = CCT: 3000K, CRI (Ra): 90+, Colour Consistency: 2SDCM</p> <p>W35H = CCT: 3500K, CRI (Ra): 90+, Colour Consistency: 2SDCM</p> <p>W41H = CCT: 4100K, CRI (Ra): 90+, Colour Consistency: 3SDCM</p>
Standard Compliance	✓ADA-compliant ✓WELL standard – Feature 58: Color Quality
Weight	2.02lbs (0.914kg). Typical Aluminum Fixture.
Material	Fixture: machined marine-grade aluminum with tempered glass
Supplied with	Driver: Non-dimmable integral driver included.
Warranty & LED Life	5 years limited warranty Estimated useful life of LED is 50,000 hours.

Ordered Separately

System Components	<p>Power supplies: dimming controller for 0-10V dimming option.</p> <p>Please consult factory or visit Recommended Drivers for available driver options.</p>
-------------------	---

Mounting Options & Dimensions

LED Insert Dimensions

Fixture

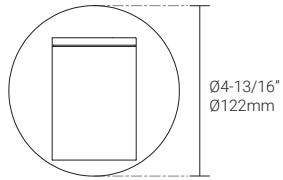

Side View

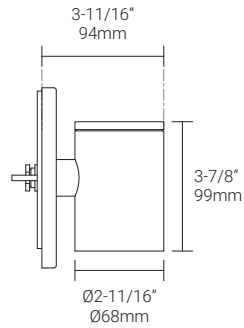

3D View



Beam

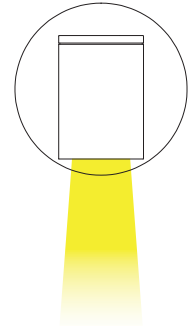

Fixture shown with internal angle bracket

Internal Angle Bracket: 0°

Internal Angle Bracket: 30° (Max.)

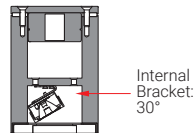
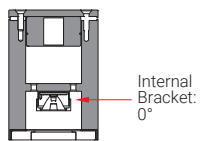
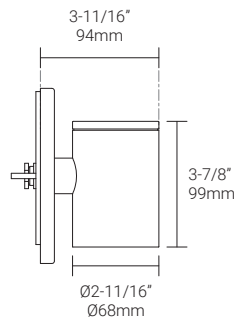
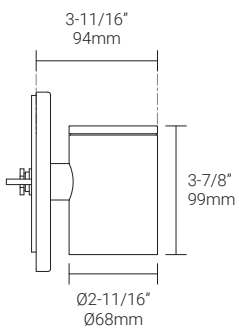

2W, 3000K, 90+ CRI, Clear Lens, Internal angle bracket: 0° (no angle bracket)

Polar Candela Distribution

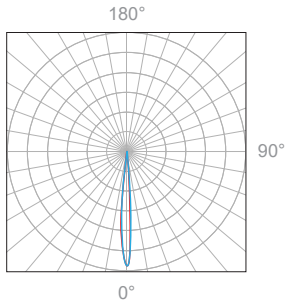

Beam Width: 12°



Illuminance at a Distance

Distance		Center Beam fc	Beam Width			
3.0ft	0.91m	36.3fc	1.0ft	0.30m	1.0ft	0.30m
6.0ft	1.83m	9.1fc	2.1ft	0.64m	2.1ft	0.64m
9.0ft	2.74m	4.0fc	3.1ft	0.95m	3.1ft	0.95m
12.0ft	3.66m	2.3fc	4.2ft	1.28m	4.2ft	1.28m
15.0ft	4.57m	1.5fc	5.2ft	1.58m	5.2ft	1.58m
18.0ft	5.49m	1.0fc	6.3ft	1.92m	6.3ft	1.92m

Delivered Lumen: 66.7 lm
 ■ Vertical Beam Spread: 19.7°
 ■ Horizontal Beam Spread: 19.4°

Polar Candela Distribution

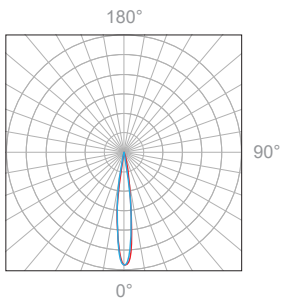

Beam Width: 30°

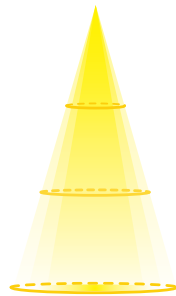

Illuminance at a Distance

Distance		Center Beam fc	Beam Width			
3.0ft	0.91m	33.4fc	1.7ft	0.52m	1.7ft	0.52m
6.0ft	1.83m	8.4fc	3.4ft	1.04m	3.4ft	1.04m
9.0ft	2.74m	3.7fc	5.1ft	1.55m	5.1ft	1.55m
12.0ft	3.66m	2.1fc	6.9ft	2.10m	6.9ft	2.10m
15.0ft	4.57m	1.3fc	8.6ft	2.62m	8.6ft	2.62m
18.0ft	5.49m	0.9fc	10.3ft	3.14m	10.3ft	3.14m

Delivered Lumen: 102.1 lm
 ■ Vertical Beam Spread: 31.9°
 ■ Horizontal Beam Spread: 31.7°

Polar Candela Distribution

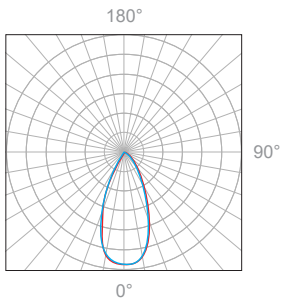

Beam Width: 45°

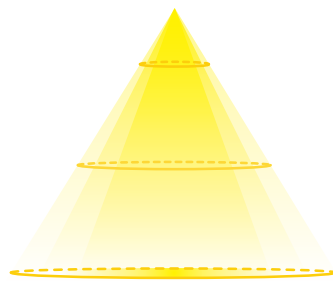

Illuminance at a Distance

Distance		Center Beam fc	Beam Width			
3.0ft	0.91m	22.9fc	2.6ft	0.79m	2.6ft	0.79m
6.0ft	1.83m	5.72fc	5.2ft	1.58m	5.2ft	1.58m
9.0ft	2.74m	2.54fc	7.8ft	2.37m	7.8ft	2.37m
12.0ft	3.66m	1.43fc	10.4ft	3.16m	10.4ft	3.16m
15.0ft	4.57m	0.91fc	13.0ft	3.96m	13.0ft	3.96m
18.0ft	5.49m	0.64fc	15.6ft	4.75m	15.7ft	4.78m

Delivered Lumen: 139.8 lm
 ■ Vertical Beam Spread: 31.9°
 ■ Horizontal Beam Spread: 31.7°

Polar Candela Distribution

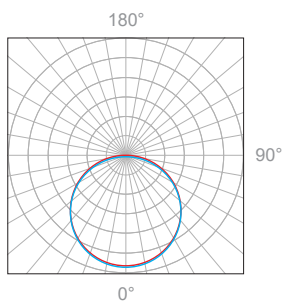

Beam Width: 120°

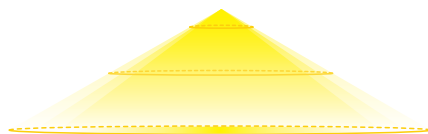

Illuminance at a Distance

Distance		Center Beam fc	Beam Width			
3.0ft	0.91m	3.41fc	4.6ft	1.40m	4.3ft	1.31m
6.0ft	1.83m	0.85fc	9.1ft	2.77m	8.5ft	2.59m
9.0ft	2.74m	0.38fc	13.7ft	4.18m	12.8ft	3.90m
12.0ft	3.66m	0.21fc	18.2ft	5.55m	17.1ft	5.21m
15.0ft	4.57m	0.14fc	22.8ft	6.95m	21.4ft	6.52m
18.0ft	5.49m	0.09fc	27.4ft	8.35m	25.6ft	7.80m

Delivered Lumen: 42 lm
 ■ Vertical Beam Spread : 74.5°
 ■ Horizontal Beam Spread : 70.9°