

M182

INTERIOR
LED integrated Wine Rack System

- Dry location

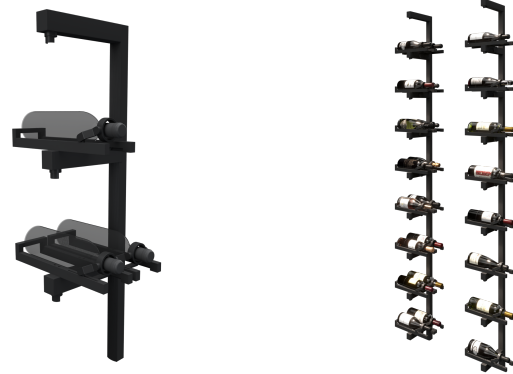

Ordering Information

Clear Form

Date : _____ Column : _____

Project : _____ Note : _____

Type : _____

Specifications

Fixture comprises of 4 components that need to be specified separately: Rail, Mounting, Arms (Top, Middle, and Bottom), and LED driver.

Luminaire | Example Code: RAL182-8-BA // WR-MB-BA // L182T-W22S-N-FS-BA // L182M-W22S-N-FS-1C-BA // L182B-1C-BA // MLED32V350Z

MOUNTING: Wall Mount Floor-to-Ceiling Mount

COMPONENT 1 – RAIL

Rail	Fixture Length ^{1.1}	Finish
RAL182		BA
RAL-182	X custom (by foot)	Aluminum Finishes: BA black anodized

COMPONENT 2 – MOUNTING

Mounting Bracket ^{2.1}	End Cap ^{2.2} (optional)
WR-MB-BA mounting bracket	WR-END-BA end cap

COMPONENT 4 – LED DRIVER

Product (1 driver per column)	Quantity
MLED32V350Z	X custom

COMPONENT 3 – ARMS

Product ^{3.1}	CCT & CRI	Beam Angle	Accessories	Finish	Quantity ^{3.4}	
L182T						
Product ^{3.2}	CCT & CRI	Beam Angle	Accessories	Cross Bar	Finish	Quantity
L182M						
Product ^{3.3}				Cross Bar	Finish	Quantity ^{3.4}
L182B						

CCT & CRI	W22S 2200K 80+ W27H 2700K 90+ W30H 3000K 90+ W35H 3500K 90+ W41H 4100K 90+
Beam Angle	S spot, 12° N narrow flood, 30° F flood 45° W wide flood, 120°
Accessories	NA no accessory AS angled shroud FS full shroud HS half shroud
Cross Bar	1C single front view 2C double front view
Finish	BA black anodized

Important Notes

Specification

- 1.1 10ft (3.05m) max. recommended length.
- 2.1 Required for Floor-to-Ceiling Mount. Includes top and bottom bracket (sold separately).
- 2.2 End Cap is only compatible with Wall Mounted installations.
- 3.1 Top Arm Module has LED and no cross bars.
- 3.2 Middle Arm Module has LED and cross bars
- 3.3 Bottom Arm Module has cross bars and no LED.
- 3.4 Quantity of top and bottom arms should match quantity of columns for single sided installations.

Warranty Notes & Disclaimer

Malfunction and damage to product due to incompatible dimming system or misuse will not be covered under warranty. Consult MP Lighting for recommended drivers. If the fixture has an option to be installed with a dimming control system, consult a dimming system manufacturer with minimum load before installing. MP Lighting reserves the right, at its sole discretion, at any time and without notice, to make design changes to any of our products. Consult MP Lighting website for most updated documentation.

M182

INTERIOR

LED integrated Wine Rack System

- Dry location



Performance

Wattage	Forward Current	Power Consumption Budget per fixture (including driver)	LED output (Source)	Fixture Output (Delivered)
1W	350mA	1.3W	110 lm	64.7-95.8 lm

Application

Environment	Dry Location approved. IP 40. Consult factory for higher IP ratings.
Mounting	<p>Wall Mount: Can be mounted directly to wall Up to 8ft (2.44m) maximum. Please contact factory for custom length taller than 8ft (2.44m)</p> <p>Floor-to-Ceiling Mount: Can be mounted freely from ceiling to floor – Mounting bracket (WR-MB, sold separately). Up to 8ft (2.44m) maximum.</p>

Electrical

Power Supplies	Remote LED drivers (converter driver from constant voltage output to constant current output, 350mA): Fixtures to be wired in series.
Control	<p>On/off control Dimming: 0-10V dimming with appropriate driver</p> <p>Other options (consult factory): Casambi</p>

Luminaire Construction

LED Light Source	<p>W22S = CCT: 2200K, CRI (Ra): 80+, Colour Consistency: 3SDCM</p> <p>W27H = CCT: 2700K, CRI (Ra): 90+, Colour Consistency: 2SDCM</p> <p>W30H = CCT: 3000K, CRI (Ra): 90+, Colour Consistency: 2SDCM</p> <p>W35H = CCT: 3500K, CRI (Ra): 90+, Colour Consistency: 2SDCM</p> <p>W41H = CCT: 4100K, CRI (Ra): 90+, Colour Consistency: 3SDCM</p>
Standard Compliance	✓ADA-compliant ✓WELL standard – Feature 58: Color Quality
Weight	N/A
Material	Fixture: Black anodized aluminum
Supplied with	Driver. Optional: waterproof (IP 66) enclosure box with 1 or 2 cable glands, and 1 vent.
Warranty & LED Life	5 years limited warranty. Estimated useful life of LED is 50,000 hours.

Ordered Separately

System Components	<p>Enclosure box: remote driver</p> <p>Please consult factory or visit Recommended Drivers for available driver options.</p> <p>Please consult factory or visit Marine Enclosure Boxes for available enclosure box options.</p>
-------------------	--

Mounting Options & Dimensions

LED Insert Dimensions (shown with 1C/2C)

Fixture

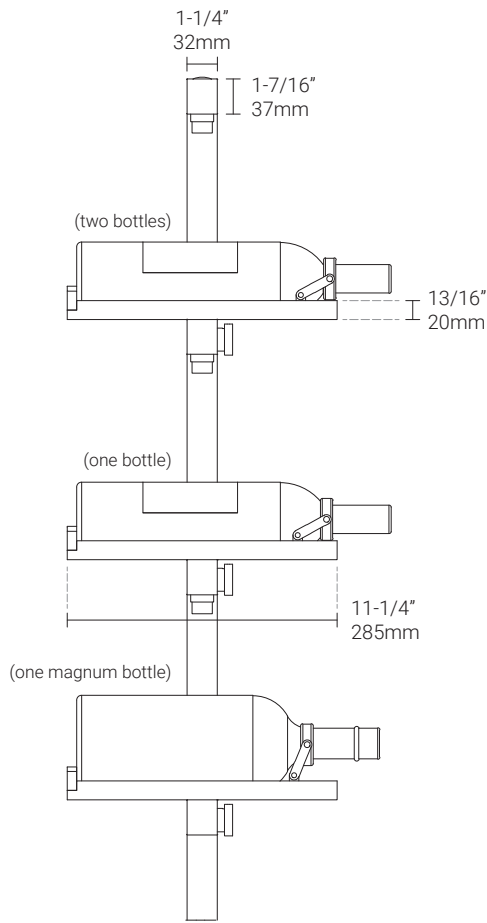

Side View

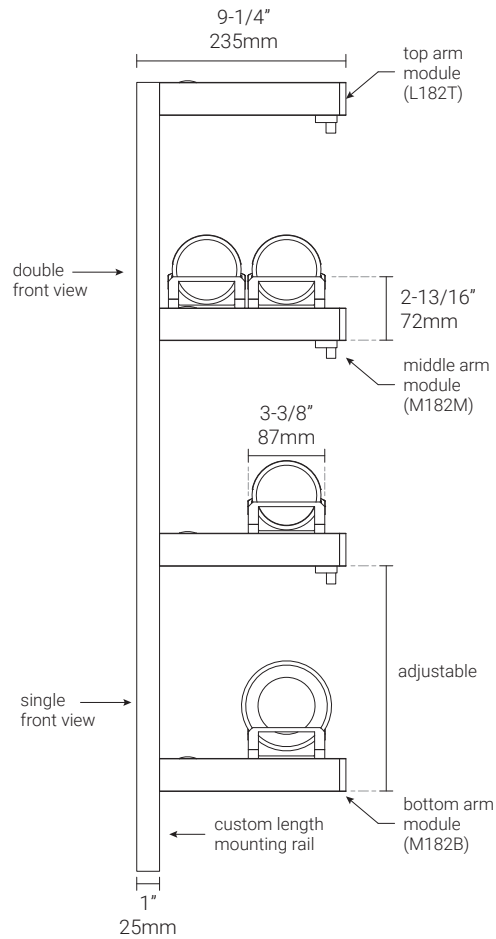

3D View



Mounting Options & Dimensions

LED Arm Dimensions

1C Arm Dimensions

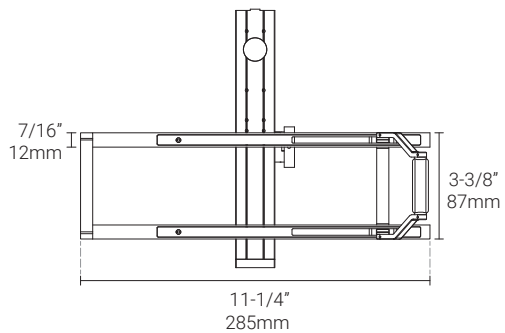

Side View

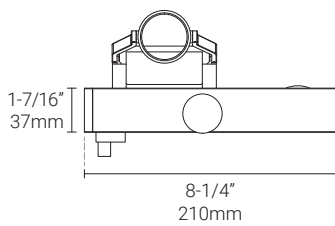

Front View

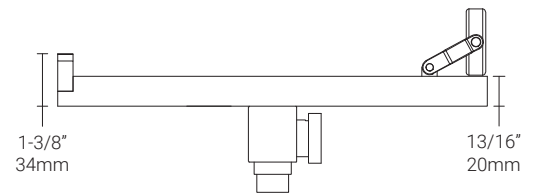

Mounting Options & Dimensions

LED Arm Dimensions

2C Arm Dimensions

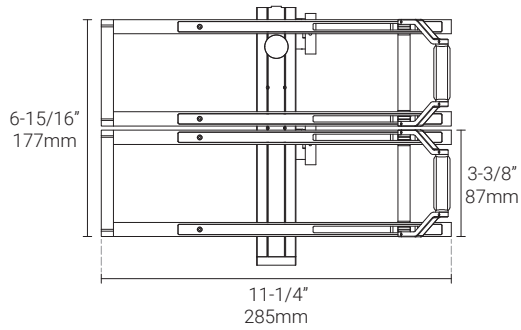

Side View

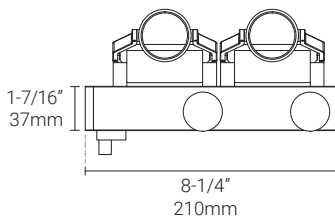

Front View

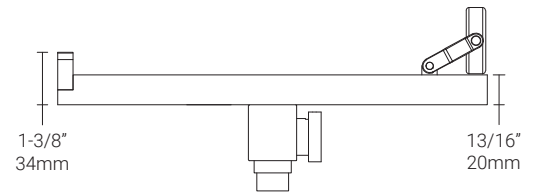

Appendix

Aluminum Finishes



BA black anodized

Bottle Holder Options



1C single front view

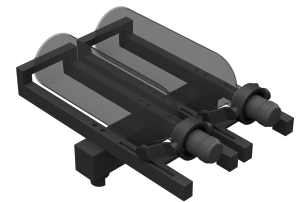

2C double front view

1W, 3000K, 90+ CRI, 12°

Polar Candela Distribution With NA (no accessories)

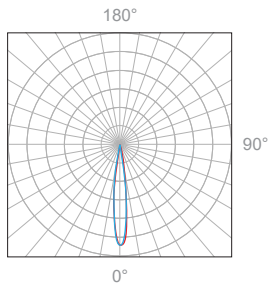

Beam width shown with NA (no accessories)



Illuminance at a Distance

Distance		Center Beam fc	Beam Width			
1.0ft	0.30m	605fc	0.3ft	0.09m	0.3ft	0.09m
2.0ft	0.61m	151fc	0.6ft	0.18m	0.6ft	0.18m
3.0ft	0.91m	67.2fc	0.9ft	0.27m	0.9ft	0.27m
4.0ft	1.22m	37.8fc	1.2ft	0.36m	1.2ft	0.36m
5.0ft	1.52m	24.2fc	1.5ft	0.45m	1.6ft	0.48m
6.0ft	1.83m	16.8fc	1.8ft	0.54m	1.9ft	0.58m

Delivered Lumen: 92.1 lm
 ■ Vertical Beam Spread: 17.3°
 ■ Horizontal Beam Spread: 17.7°

Tested on 23/05/2025

Polar Candela Distribution With HS (half shroud)

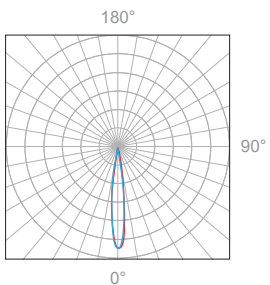

Beam width shown with HS (half shroud)



Illuminance at a Distance

Distance		Center Beam fc	Beam Width			
1.0ft	0.30m	613fc	0.3ft	0.09m	0.3ft	0.09m
2.0ft	0.61m	153fc	0.6ft	0.18m	0.6ft	0.18m
3.0ft	0.91m	68.1fc	0.9ft	0.27m	0.9ft	0.27m
4.0ft	1.22m	38.3fc	1.2ft	0.36m	1.2ft	0.36m
5.0ft	1.52m	24.5fc	1.5ft	0.45m	1.5ft	0.45m
6.0ft	1.83m	17.0fc	1.8ft	0.54m	1.8ft	0.54m

Delivered Lumen: 89.3 lm
 ■ Vertical Beam Spread: 17.1°
 ■ Horizontal Beam Spread: 17.3°

Tested on 23/05/2025

Polar Candela Distribution With FS (full shroud)

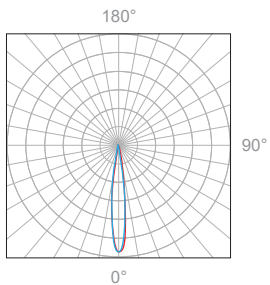

Beam width shown with FS (full shroud)



Illuminance at a Distance

Distance		Center Beam fc	Beam Width			
1.0ft	0.30m	619fc	0.3ft	0.09m	0.3ft	0.09m
2.0ft	0.61m	155fc	0.6ft	0.18m	0.6ft	0.18m
3.0ft	0.91m	68.8fc	0.9ft	0.27m	0.9ft	0.27m
4.0ft	1.22m	38.7fc	1.2ft	0.36m	1.2ft	0.36m
5.0ft	1.52m	24.8fc	1.5ft	0.45m	1.5ft	0.45m
6.0ft	1.83m	17.2fc	1.8ft	0.54m	1.7ft	0.51m

Delivered Lumen: 83.8 lm
 ■ Vertical Beam Spread: 16.7°
 ■ Horizontal Beam Spread: 16.5°

Tested on 23/05/2025

Polar Candela Distribution With AS (angled shroud)

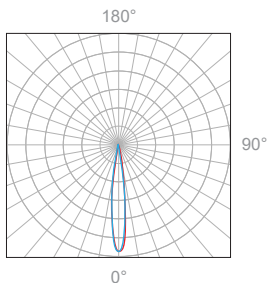

Beam width shown with AS (angled shroud)



Illuminance at a Distance

Distance		Center Beam fc	Beam Width			
1.0ft	0.30m	555fc	0.3ft	0.09m	0.3ft	0.09m
2.0ft	0.61m	139fc	0.7ft	0.21m	0.7ft	0.21m
3.0ft	0.91m	61.6fc	1.0ft	0.30m	1.0ft	0.30m
4.0ft	1.22m	34.7fc	1.3ft	0.39m	1.3ft	0.39m
5.0ft	1.52m	22.2fc	1.6ft	0.48m	1.6ft	0.48m
6.0ft	1.83m	15.4fc	2.0ft	0.61m	2.0ft	0.61m

Delivered Lumen: 88.7 lm
 ■ Vertical Beam Spread: 18.6°
 ■ Horizontal Beam Spread: 18.5°

Tested on 23/05/2025

1W, 3000K, 90+ CRI, 30°

Polar Candela Distribution With NA (no accessories)

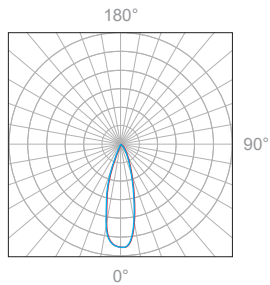

Beam width shown with NA (no accessories)

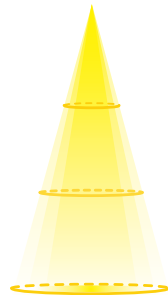

Illuminance at a Distance

Distance		Center Beam fc	Beam Width			
1.0ft	0.30m	439fc	0.4ft	0.12m	0.4ft	0.12m
2.0ft	0.61m	110fc	0.8ft	0.24m	0.8ft	0.24m
3.0ft	0.91m	48.8fc	1.3ft	0.39m	1.3ft	0.39m
4.0ft	1.22m	27.4fc	1.7ft	0.51m	1.7ft	0.51m
5.0ft	1.52m	17.6fc	2.1ft	0.64m	2.1ft	0.64m
6.0ft	1.83m	12.2fc	2.5ft	0.76m	2.5ft	0.76m

Delivered Lumen: 95.8 lm
 ■ Vertical Beam Spread: 23.9°
 ■ Horizontal Beam Spread: 23.9°

Tested on 23/05/2025

Polar Candela Distribution With HS (half shroud)

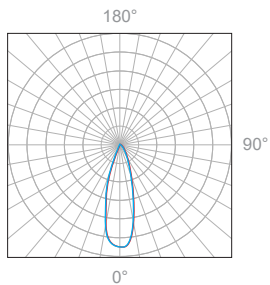

Beam width shown with HS (half shroud)



Illuminance at a Distance

Distance		Center Beam fc	Beam Width			
1.0ft	0.30m	439fc	0.4ft	0.12m	0.4ft	0.12m
2.0ft	0.61m	110fc	0.8ft	0.24m	0.9ft	0.27m
3.0ft	0.91m	48.8fc	1.2ft	0.36m	1.3ft	0.39m
4.0ft	1.22m	27.4fc	1.6ft	0.48m	1.7ft	0.51m
5.0ft	1.52m	17.6fc	2.1ft	0.64m	2.2ft	0.67m
6.0ft	1.83m	12.2fc	2.5ft	0.76m	2.6ft	0.79m

Delivered Lumen: 94.2 lm
 ■ Vertical Beam Spread: 23.2°
 ■ Horizontal Beam Spread: 24.4°

Tested on 23/05/2025

Polar Candela Distribution With FS (full shroud)

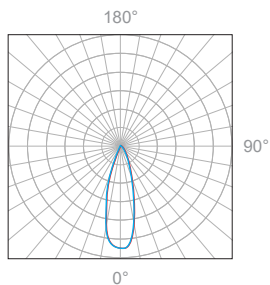

Beam width shown with FS (full shroud)

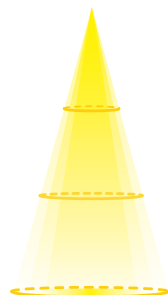

Illuminance at a Distance

Distance		Center Beam fc	Beam Width			
1.0ft	0.30m	455fc	0.4ft	0.12m	0.4ft	0.12m
2.0ft	0.61m	114fc	0.9ft	0.27m	0.8ft	0.24m
3.0ft	0.91m	50.6fc	1.3ft	0.39m	1.2ft	0.36m
4.0ft	1.22m	28.4fc	1.7ft	0.51m	1.6ft	0.48m
5.0ft	1.52m	18.2fc	2.1ft	0.64m	2.0ft	0.61m
6.0ft	1.83m	12.6fc	2.6ft	0.79m	2.4ft	0.73m

Delivered Lumen: 89.1 lm
 ■ Vertical Beam Spread: 24°
 ■ Horizontal Beam Spread: 22.5°

Tested on 23/05/2025

Polar Candela Distribution With AS (angled shroud)

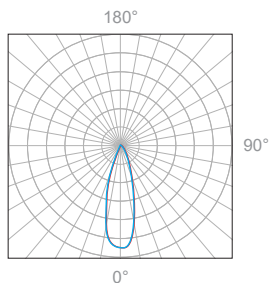

Beam width shown with AS (angled shroud)

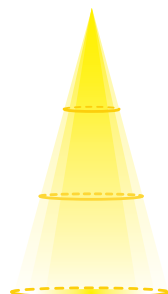

Illuminance at a Distance

Distance		Center Beam fc	Beam Width			
1.0ft	0.30m	439fc	0.4ft	0.12m	0.4ft	0.12m
2.0ft	0.61m	110fc	0.8ft	0.24m	0.9ft	0.27m
3.0ft	0.91m	48.8fc	1.2ft	0.36m	1.3ft	0.39m
4.0ft	1.22m	27.4fc	1.6ft	0.48m	1.7ft	0.51m
5.0ft	1.52m	17.6fc	2.0ft	0.61m	2.1ft	0.64m
6.0ft	1.83m	12.2fc	2.4ft	0.73m	2.5ft	0.76m

Delivered Lumen: 90.5 lm
 ■ Vertical Beam Spread: 22.6°
 ■ Horizontal Beam Spread: 23.8°

Tested on 23/05/2025

1W, 3000K, 90+ CRI, 45°

Polar Candela Distribution With NA (no accessories)

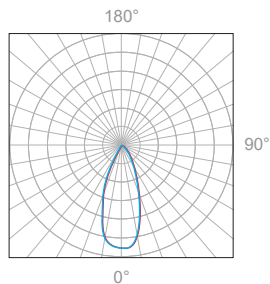

Beam width shown with NA (no accessories)

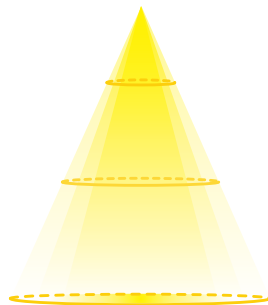

Illuminance at a Distance

Distance		Center Beam fc	Beam Width			
1.0ft	0.30m	116fc	0.9ft	0.27m	0.9ft	0.27m
2.0ft	0.61m	28.9fc	1.8ft	0.54m	1.8ft	0.54m
3.0ft	0.91m	12.9fc	2.7ft	0.82m	2.7ft	0.82m
4.0ft	1.22m	7.24fc	3.5ft	1.06m	3.6ft	1.09m
5.0ft	1.52m	4.63fc	4.4ft	1.34m	4.6ft	1.40m
6.0ft	1.83m	3.22fc	5.3ft	1.61m	5.5ft	1.67m

Delivered Lumen: 86.3 lm
 ■ Vertical Beam Spread: 47.9°
 ■ Horizontal Beam Spread: 49°

Tested on 23/05/2025

Polar Candela Distribution With HS (half shroud)

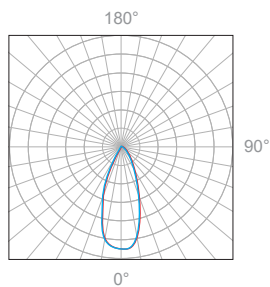

Beam width shown with HS (half shroud)

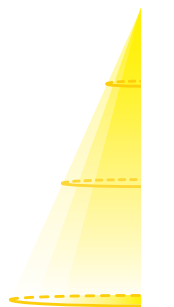

Illuminance at a Distance

Distance		Center Beam fc	Beam Width			
1.0ft	0.30m	117fc	0.9ft	0.27m	0.9ft	0.27m
2.0ft	0.61m	29.3fc	1.7ft	0.51m	1.7ft	0.51m
3.0ft	0.91m	13.0fc	2.6ft	0.79m	2.6ft	0.79m
4.0ft	1.22m	7.34fc	3.5ft	1.06m	3.4ft	1.03m
5.0ft	1.52m	4.69fc	4.3ft	1.31m	4.3ft	1.31m
6.0ft	1.83m	3.26fc	5.2ft	1.58m	5.1ft	1.55m

Delivered Lumen: 82.7 lm
 ■ Vertical Beam Spread: 47°
 ■ Horizontal Beam Spread: 46.2°

Tested on 23/05/2025

Polar Candela Distribution With FS (full shroud)

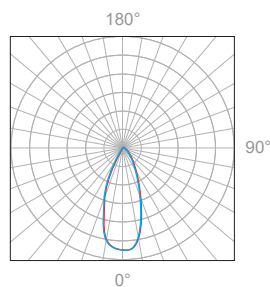

Beam width shown with FS (full shroud)

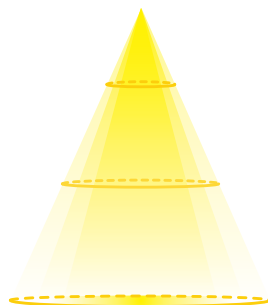

Illuminance at a Distance

Distance		Center Beam fc	Beam Width			
1.0ft	0.30m	116fc	0.8ft	0.24m	0.8ft	0.24m
2.0ft	0.61m	28.9fc	1.6ft	0.48m	1.6ft	0.48m
3.0ft	0.91m	12.9fc	2.4ft	0.73m	2.5ft	0.76m
4.0ft	1.22m	7.24fc	3.3ft	1.00m	3.3ft	1.00m
5.0ft	1.52m	4.63fc	4.1ft	1.24m	4.1ft	1.24m
6.0ft	1.83m	3.22fc	4.9ft	1.49m	4.9ft	1.49m

Delivered Lumen: 73.4 lm
 ■ Vertical Beam Spread: 44.4°
 ■ Horizontal Beam Spread: 44.5°

Tested on 23/05/2025

Polar Candela Distribution With AS (angled shroud)

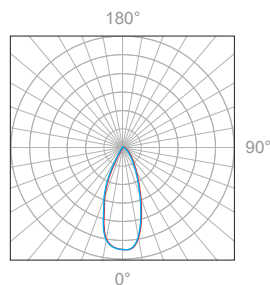

Beam width shown with AS (angled shroud)

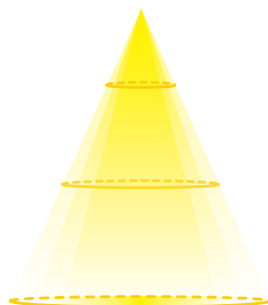

Illuminance at a Distance

Distance		Center Beam fc	Beam Width			
1.0ft	0.30m	135fc	0.8ft	0.24m	0.8ft	0.24m
2.0ft	0.61m	33.8fc	1.6ft	0.48m	1.7ft	0.51m
3.0ft	0.91m	15.0fc	2.5ft	0.76m	2.5ft	0.76m
4.0ft	1.22m	8.44fc	3.3ft	1.00m	3.3ft	1.00m
5.0ft	1.52m	5.40fc	4.1ft	1.24m	4.1ft	1.24m
6.0ft	1.83m	3.75fc	4.9ft	1.49m	5.0ft	1.52m

Delivered Lumen: 87.4 lm
 ■ Vertical Beam Spread: 44.6°
 ■ Horizontal Beam Spread: 44.9°

Tested on 23/05/2025

1W, 3000K, 90+ CRI, 120°

Polar Candela Distribution With NA (no accessories)

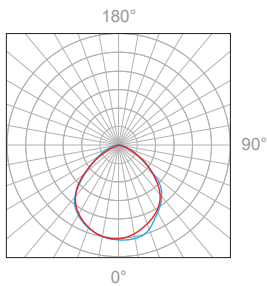

Beam width shown with NA (no accessories)

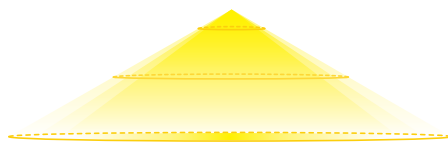

Illuminance at a Distance

Distance		Center Beam fc	Beam Width			
1.0ft	0.30m	38.6fc	2.3ft	0.70m	2.3ft	0.70m
2.0ft	0.61m	9.65fc	4.5ft	1.37m	4.5ft	1.37m
3.0ft	0.91m	4.29fc	6.8ft	2.07m	6.8ft	2.07m
4.0ft	1.22m	2.41fc	9.1ft	2.77m	9.1ft	2.77m
5.0ft	1.52m	1.54fc	11.4ft	3.47m	11.3ft	3.44m
6.0ft	1.83m	1.07fc	13.6ft	4.14m	13.6ft	4.14m

Delivered Lumen: 84.1 lm
 ■ Vertical Beam Spread: 97.3°
 ■ Horizontal Beam Spread: 97.2°

Tested on 23/05/2025

Polar Candela Distribution With HS (half shroud)

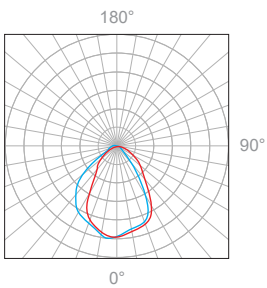

Beam width shown with HS (half shroud)

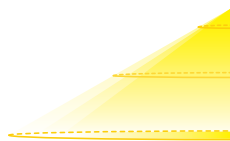

Illuminance at a Distance

Distance		Center Beam fc	Beam Width			
1.0ft	0.30m	40.2fc	2.4ft	0.73m	1.8ft	0.54m
2.0ft	0.61m	10.1fc	4.9ft	1.49m	3.6ft	1.09m
3.0ft	0.91m	4.47fc	7.3ft	2.22m	5.4ft	1.64m
4.0ft	1.22m	2.51fc	9.7ft	2.95m	7.2ft	2.19m
5.0ft	1.52m	1.61fc	12.1ft	3.68m	9.0ft	2.74m
6.0ft	1.83m	1.12fc	14.6ft	4.45m	10.8ft	3.29m

Delivered Lumen: 71.4 lm
 ■ Vertical Beam Spread: 101.1°
 ■ Horizontal Beam Spread: 83.9°

Tested on 23/05/2025

Polar Candela Distribution With FS (full shroud)

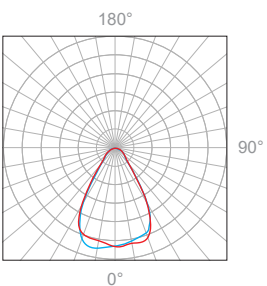

Beam width shown with FS (full shroud)

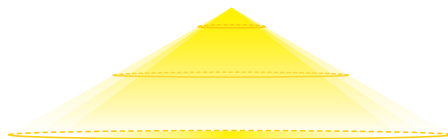

Illuminance at a Distance

Distance		Center Beam fc	Beam Width			
3.0ft	0.91m	40.2fc	0.9ft	0.27m	1.2ft	0.37m
6.0ft	1.83m	10.1fc	1.8ft	0.54m	2.4ft	0.73m
9.0ft	2.74m	4.47fc	2.7ft	0.82m	3.6ft	1.10m
12.0ft	3.66m	2.51fc	3.6ft	1.09m	4.8ft	1.46m
15.0ft	4.57m	1.61fc	4.4ft	1.34m	6.0ft	1.83m
18.0ft	5.49m	1.12fc	5.3ft	1.61m	7.2ft	2.19m

Delivered Lumen: 64.7 lm
 ■ Vertical Beam Spread: 48°
 ■ Horizontal Beam Spread: 61.7°

Tested on 23/05/2025

Polar Candela Distribution With AS (angled shroud)

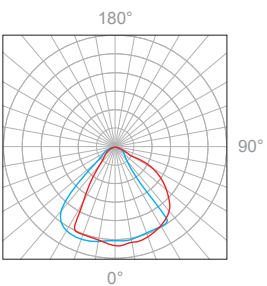

Beam width shown with AS (angled shroud)

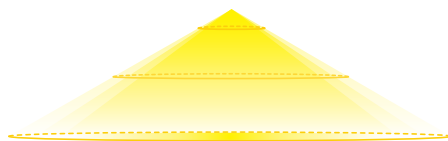

Illuminance at a Distance

Distance		Center Beam fc	Beam Width			
3.0ft	0.91m	50.8fc	1.9ft	0.58m	1.8ft	0.54m
6.0ft	1.83m	12.7fc	3.8ft	1.15m	3.7ft	1.12m
9.0ft	2.74m	5.64fc	5.7ft	1.73m	5.5ft	1.67m
12.0ft	3.66m	3.17fc	7.6ft	2.31m	7.4ft	2.25m
15.0ft	4.57m	2.03fc	9.5ft	2.89m	9.2ft	2.80m
18.0ft	5.49m	1.41fc	11.3ft	3.44m	11.1ft	3.38m

Delivered Lumen: 77.2 lm
 ■ Vertical Beam Spread: 86.8°
 ■ Horizontal Beam Spread: 85.5°

Tested on 23/05/2025